

APN: 162-20-211-003

WHEN RECORDED, RETURN TO:
Clark County Department of Public Works
Attention: Public Works Survey Division
500 South Grand Central Parkway, Suite 2017
Las Vegas, Nevada 89106

DEDICATION IN FEE

COUNTY OF CLARK, a political subdivision of the State of Nevada, "Dedicator", does hereby dedicate for roadway and drainage purposes, that tract or parcel of land located in the County of Clark, State of Nevada, described as follows:

Harmon Avenue – Valley View Boulevard Interchange

A PORTION OF LOT 3, AS SHOWN BY MAP THEREOF ON FILE IN FILE 56, PAGE 67, OF PLATS, OFFICIAL RECORDS, CLARK COUNTY, NEVADA, LYING WITHIN THE SOUTHWEST QUARTER (SW 1/4) OF THE NORTHWEST QUARTER (NW 1/4) OF SECTION 20, TOWNSHIP 21 SOUTH, RANGE 61 EAST, M. D. M., CLARK COUNTY, NEVADA, DESCRIBED AS FOLLOWS:

Exhibits "A" and "B" attached hereto and by this reference made a part hereof.

Assessor's Parcel No.:162-20-211-003

IN WITNESS WHEREOF, we have hereunto set our hands this ____ day of _____, 2021.

ATTEST:

CLARK COUNTY, NEVADA

BY: _____

LYNN MARIE GOYA
County Clerk

BY: _____

RANDALL J. TARR
Assistant County Manager

**OWNER: COUNTY OF CLARK
APN 162-20-211-003**

**EXHIBIT "A"
DESCRIPTION**

A PORTION OF LOT 3 AS SHOWN ON BOOK 56, PAGE 67 OF PLATS ON FILE AT THE CLARK COUNTY, NEVADA, RECORDER'S OFFICE, LYING WITHIN THE NORTHWEST QUARTER (NW 1/4) OF SECTION 20, TOWNSHIP 21 SOUTH, RANGE 61 EAST, M.D.M., CLARK COUNTY, NEVADA, DESCRIBED AS FOLLOWS:

COMMENCING AT THE SOUTHWEST CORNER OF SAID NORTHWEST QUARTER (NW 1/4); THENCE ALONG THE WEST LINE THEREOF, NORTH 01°29'16" WEST, 981.26 FEET; THENCE DEPARTING SAID WEST LINE, NORTH 88°30'44" EAST, 50.00 FEET TO A POINT ON THE EASTERLY RIGHT-OF-WAY OF VALLEY VIEW BOULEVARD, DESCRIBED IN THAT GRANT DEED, RECORDED NOVEMBER 22, 1966, IN BOOK 759 AS INSTRUMENT NUMBER 610350, ON FILE AT SAID RECORDER'S OFFICE, SAID POINT BEING THE NORTHWEST CORNER LOT 1 AS SHOWN IN SAID PLAT; THENCE ALONG THE NORTHERLY LINE THEREOF AND THE NORTHERLY LINE OF LOT 2 OF SAID PLAT, SOUTH 89°33'18" EAST, 187.31 FEET TO THE NORTHWEST CORNER OF SAID LOT 3, SAID CORNER BEING THE **POINT OF BEGINNING**; THENCE ALONG THE NORTHERLY LINE OF SAID LOT 3 AND CONTINUING SOUTH 89°33'18" EAST, 79.37 FEET TO THE BEGINNING OF A CURVE, CONCAVE TO THE NORTH, HAVING A RADIUS OF 676.90 FEET; THENCE EASTERLY ALONG SAID NORTHERLY LINE AND SAID CURVE, THROUGH A CENTRAL ANGLE OF 04°22'29", AN ARC LENGTH OF 51.68 FEET TO THE BEGINNING OF A NON-TANGENT CURVE, CONCAVE TO THE SOUTHWEST, HAVING A RADIUS OF 201.00 FEET, FROM WHICH BEGINNING THE RADIUS BEARS SOUTH 29°21'45" WEST; THENCE DEPARTING SAID NORTHERLY LINE AND SOUTHEASTERLY ALONG SAID CURVE, THROUGH A CENTRAL ANGLE OF 43°01'19", AN ARC LENGTH OF 150.93 FEET TO THE BEGINNING OF A COMPOUND CURVE, CONCAVE TO THE WEST, HAVING A RADIUS OF 471.00 FEET, FROM WHICH BEGINNING THE RADIUS BEARS SOUTH 72°23'04" WEST; THENCE SOUTHERLY ALONG SAID CURVE, THROUGH A CENTRAL ANGLE OF 04°45'06", AN ARC LENGTH OF 39.06 FEET TO A POINT ON THE SOUTHEASTERLY LINE OF SAID LOT 3, SAME BEING THE NORTHWESTERLY RIGHT-OF-WAY OF THE UNION PACIFIC RAILROAD; THENCE ALONG SAID SOUTHEASTERLY LINE AND NORTHWESTERLY RIGHT-OF-WAY THE FOLLOWING TWO (2) COURSES: 1) SOUTH 27°39'39" WEST, 190.52 FEET TO THE BEGINNING OF A CURVE, CONCAVE TO THE SOUTHEAST, HAVING A RADIUS OF 23,174.35 FEET; 2) SOUTHWESTERLY ALONG SAID CURVE, THROUGH A CENTRAL ANGLE OF 00°15'04", AN ARC LENGTH OF 101.53 FEET TO THE MOST SOUTHERLY CORNER OF SAID LOT 3; THENCE DEPARTING SAID SOUTHEASTERLY LINE AND NORTHWESTERLY RIGHT-OF-WAY, ALONG THE SOUTHERLY AND WESTERLY BOUNDARY LINE OF SAID LOT 3 THE FOLLOWING THREE (3) COURSES: 1) NORTH 01°11'52" WEST, 87.94 FEET; 2) NORTH 89°29'27" WEST, 99.69 FEET; 3) NORTH 00°27'54" EAST, 321.05 FEET TO THE **POINT OF BEGINNING**.

CONTAINS 65,023 SQUARE FEET, MORE OR LESS.

OWNER: COUNTY OF CLARK
APN 162-20-211-003

BASIS OF BEARINGS

NORTH 01°29'16" WEST, BEING THE BEARING OF THE WEST LINE OF THE SOUTHWEST QUARTER (SW 1/4) OF THE NORTHWEST QUARTER (NW 1/4) OF SECTION 20, TOWNSHIP 21 SOUTH, RANGE 61 EAST, M.D.M., CLARK COUNTY, NEVADA, AS SHOWN IN FILE 219, PAGE 45 OF SURVEYS ON FILE AT THE CLARK COUNTY RECORDER'S OFFICE.

END OF DESCRIPTION

(SEE EXHIBIT "B" ATTACHED HERETO AND BY THIS REFERENCE MADE A PART HEREOF)

PAUL BURN, PLS
PROFESSIONAL LAND SURVEYOR
NEVADA LICENSE NO. 11174

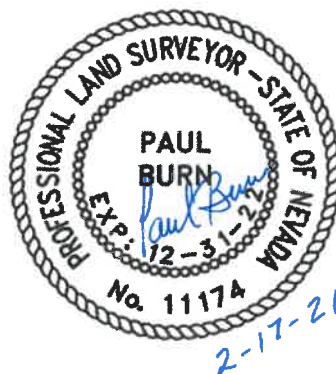
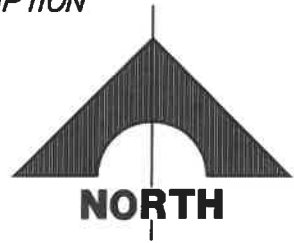

EXHIBIT "B" TO ACCOMPANY DESCRIPTION
 OWNER: COUNTY OF CLARK
 APN: 162-20-211-003



N 1/16 19 | 20

POINT OF BEGINNING

OR: 20081223: 02927 1" = 80'

VALLEY VIEW BOULEVARD
 BASIS OF BEARINGS
 N01°29'16"W 1323.93'
 981.26'

342.67'

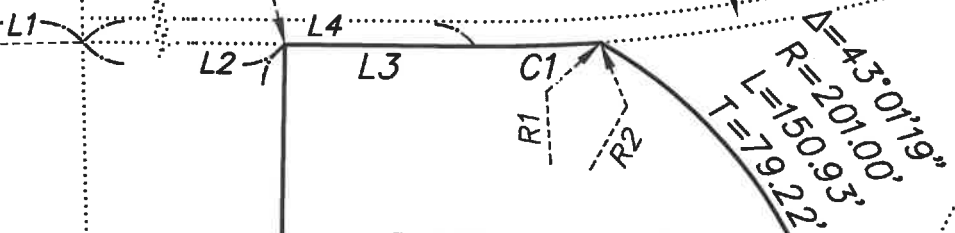

PORTION OF LOT 3
 BOOK 56, PAGE 67 OF
 PLATS

AREA = 65,023 S.F.±

OR: 20060530: 03693
 N00°27'54"E 321.05'

S27°39'39"W
 190.52'
 UPPR

OR: 20121203: 02234

POINT OF COMMENCEMENT
 1/4 19 | 20

F: \Projects\500-901A\Division\Srvy\Exhibits\162-20-211-003 DED EX01.dwg

NOTE: SEE PAGE 2 FOR LINE, RADIAL AND CURVE TABLES

OWNER: COUNTY OF CLARK
 APN: 162-20-211-013

EXHIBIT "B" TO ACCOMPANY DESCRIPTION

LINE TABLE

LINE	BEARING	LENGTH
L1	N88°30'44"E	50.00'
L2	S89°33'18"E	187.31'
L3	S89°33'18"E	79.37'
L4	S89°33'18"E	266.68'
L5	S01°11'52"E	87.94'
L6	N89°29'27"W	99.69'

CURVE TABLE

NO.	DELTA	RADIUS	LENGTH	TANGENT
C1	4°22'29"	676.90'	51.68'	25.85'
C2	4°45'06"	471.00'	39.06'	19.54'
C3	0°15'04"	23174.35'	101.53'	50.77'

RADIAL TABLE

LINE	BEARING
R1	N03°55'47"W
R2	S29°21'45"W
R3	S72°23'04"W
R4	S77°08'10"W
R5	S62°35'25"E