

APNs: 126-36-101-022  
126-36-101-024

MAIL TAX STATEMENTS AND  
WHEN RECORDED, RETURN TO:  
Clark County Department of Public Works  
Attention: Antonio Papazian, Manager Development Review  
500 South Grand Central Parkway, Suite 2001  
Las Vegas, Nevada 89106

---

**DEDICATION IN FEE**

**COUNTY OF CLARK, a political subdivision of the State of Nevada, "Dedicator", does hereby dedicate for the Western Clark County 215 Bruce Woodbury Beltway, a controlled access facility that parcel of land located in the County of Clark, State of Nevada, described as follows:**

**WESTERN CLARK COUNTY 215 BRUCE WOODBURY BELTWAY**

**THAT PORTION OF SECTION 36, TOWNSHIP 19 SOUTH, RANGE 59 EAST, M.D.M., CLARK COUNTY, NEVADA, DESCRIBED AS FOLLOWS:**

**Exhibits "A" and "B" attached hereto and by this reference made a part hereof.**

Assessor's Parcel Nos.: 126-36-101-022  
126-36-101-024

Signature of individual reviewing and approving  
document \_\_\_\_\_  
Antonio Papazian, Manager Development Review  
Department Public Works Date \_\_\_\_\_

**IN WITNESS WHEREOF**, we have hereunto set our hands this \_\_\_\_ day of \_\_\_\_\_, 2022.

**ATTEST:**

**CLARK COUNTY, NEVADA**

BY: \_\_\_\_\_  
**LYNN MARIE GOYA**  
County Clerk

BY: \_\_\_\_\_  
**RANDALL J. TARR**  
Deputy County Manager

APN: 126-36-101-024, 126-36-101-022

EXHIBIT A



**RIGHT-OF-WAY DEDICATION FOR WESTERN CLARK COUNTY  
215 BRUCE WOODBURY BELTWAY.**

**Explanation**

A description of a portion of Assessor's Parcel Number 126-36-101-022 and 024, generally located Northeasterly of the intersection of Ann Road and Schaumber Road.

**Legal Description**

A portion of that parcel contained in Book 19981201 as Instrument Number 0002426, on file in the Office of the Clark County, Nevada, Recorder, described as follows:

**Beginning** at the Southeast corner of the East Half (E1/2) of the Northwest Quarter (NW1/4) of the Northeast Quarter (NE1/4) of the Northwest Quarter (NW1/4) of Section 36, Township 19 South, Range 59 East, Mount Diablo Meridian, County of Clark, State of Nevada, thence along the south line of said East Half (1/2) of the Northwest Quarter (NW1/4) of the Northeast Quarter (NE1/4) of the Northwest Quarter (NW1/4), South 89°25'08" West a distance of 251.28 feet to the northwest corner of Right-of-Way document No. 20210913:00889; thence along the projection of the westerly boundary of said document North 34°54'43" West, 148.87 feet to a point on the west line of said East Half (E1/2) of the Northwest Quarter (NW1/4) of the Northeast Quarter (NE1/4) of the Northwest Quarter (NW1/4); thence along said west line North 00°17'16" East a distance of 2.11 feet to a point on the southerly right-of-way of Ann Road (Publicly Dedicated Or.20160715:001371) (width varies); thence along said right-of-way North 60°22'26" East a distance of 127.82 feet; thence North 60°27'53" East, 260.95 feet to a point on the east line of the East Half (E1/2) of the Northwest Quarter (NW1/4) of the Northeast Quarter (NE1/4) of the Northwest Quarter (NW1/4) of said Section 36; thence along said east line South 00°18'38" West a distance of 313.47 feet to the **Point of Beginning**.

Together with any and all abutter's rights and access rights along and across the control of access line as shown on Exhibit "B" attached hereto and made a part hereof.

This description contains 68,665 square feet as determined by computer methods, as shown on the attached Exhibit "B" display map to accompany legal description attached hereto and made a part hereof.



**Basis of Bearings:** North 00°15'55" East, being the west line of the Northeast Quarter (NE1/4) of the Northwest Quarter (NW1/4) of Section 36, Township 19 South, Range 59 East, Mount Diablo Meridian, as recorded in Book 163 of Plats at Page 53, Official Records, Clark County, Nevada.

**End of Legal Description**

Boyd R Urie, PLS  
Professional Land Surveyor  
Nevada License No. 8614

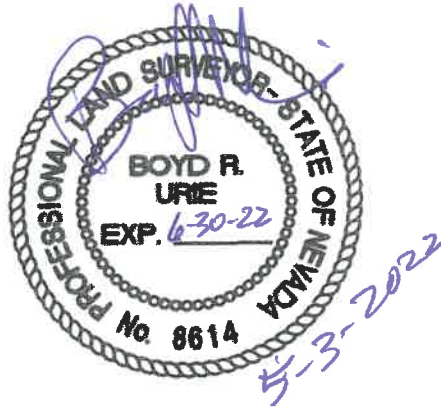

APN: 126-36-101-024

EXHIBIT B

**ANN ROAD**  
OR. 20160715: 001371



APN 126-36-101-022  
APN 126-36-101-024  
COUNTY OF CLARK  
OR: 19981201-00002426

313.47'  
S00°18'38"W  
APN 126-36-101-020  
COUNTY OF CLARK  
OR: 19970909-0000371

APN  
126-36-101-026  
COUNTY OF CLARK  
OR: 19981201-00002426

AREA=68,665 SQ.FT.

CONTROL OF  
ACCESS LINE

POINT OF BEGINNING  
SE COR. E1/2 NW1/4 NE1/4  
NW1/4 SEC. 36, T. 19S.,  
R. 59E., M.D.M.

APN 126-36-101-008

LV 215 LLC

W1/2 SW1/4 NE1/4

NW1/4 SEC. 36,

T. 19 S., R. 59 E., M.D.M.

APN 126-36-101-017

ANN AT 215 LLC

E1/2 SW1/4 NE1/4

NW1/4 SEC. 36,

T. 19 S., R. 59 E., M.D.M.

APN 126-36-199-012  
PUBLIC RIGHT-OF-WAY  
OR.: 20210913: 000889

S89°25'08"W

251.28'

**CC 215  
BELTWAY**

 **SMITH & Associates**  
LAND SURVEYING, LLC

WWW.SMITHLANDSURVEY.COM  
(702) 724-2694  
6725 S. EASTERN AVENUE, SUITE 7  
LAS VEGAS, NEVADA 89119  
AVISION DEVELOPMENT PARTNERS  
TRANSFER PARCEL NO. 1  
CVL012106  
04/21/2022  
BRU  
3 OF 3