

EXHIBIT 1

This map is for assessment use only and does NOT represent a survey.

No liability is assumed for the accuracy of the data delineated herein. Information on roads and other non-assessed parcels may be obtained from the Road Document Listing in the Assessor's Office.

This map is compiled from official records, including surveys and deeds, but only contains the information required for assessment. See the recorded documents for more detailed legal information.

USE THIS SCALE(FEET) WHEN MAP REDUCED FROM 11X17 ORIGINAL

ASSESSOR'S PARCELS - CLARK COUNTY, NV.

Briana Johnson - Assessor

125	124	123
138	139	140
163	162	161

Scale: 1" = 200'

MAP LEGEND

- PARCEL BOUNDARY
- SUB BOUNDARY
- PMLD BOUNDARY
- ROAD EASEMENT
- MATCH / LEADER LINE
- HISTORIC LOT LINE
- HISTORIC SUB BOUNDARY
- HISTORIC PMLD BOUNDARY
- SECTION LINE
- TAX DISTRICT LINE

- CONDOMINIUM UNIT
- AIR SPACE PCL
- RIGHT OF WAY PCL
- SUB-SURFACE PCL

001 ROAD PARCEL NUMBER

001 PARCEL NUMBER

1.00 ACREAGE

202 PARCEL SUB/SEQ NUMBER

PB 24-45 PLAT RECORDING NUMBER

5 BLOCK NUMBER

5 LOT NUMBER

GL5 GOV. LOT NUMBER

BOON: T20S R61E

SEC: 27

MAP: S 2 NW 4

139-27-2

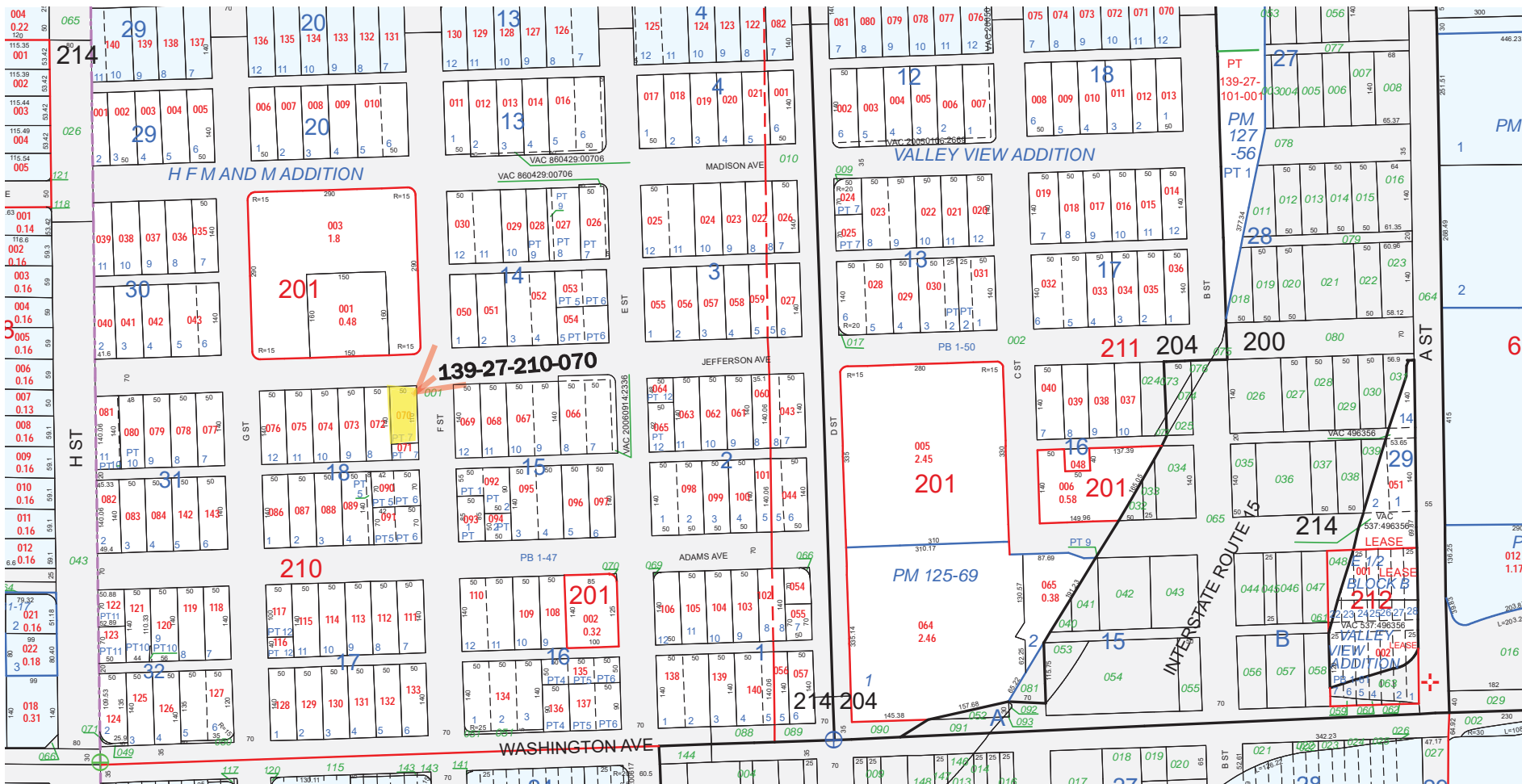

TAX DIST 200,204,214

MEMORANDUM

ADMINISTRATIVE SERVICES

LES LEE SHELL
Deputy County Manager

TO: Commissioner McCurdy
FROM: Les Lee Shell, Deputy County Manager
SUBJECT: Entity Request for Transfer of Parcel
DATE: March 1, 2022

Attached, please find documents requesting the transfer of six parcels (139-22-310-027, 139-27-111-025, 139-27-210-070, 139-27-310-023, 139-27-811-015 and 139-27-811-016) to a public entity in lieu of public auction. In accordance with NRS 361.603, any local government is allowed to acquire real property for a public purpose. It has been determined that this request meets this requirement.

Please indicate your approval/disapproval by notation below and return to my attention. If you have any questions or need additional information, please do not hesitate to contact me directly.

Thank you in advance for your consideration.

Request Approved:



Request Denied:

MEMORANDUM

CLARK COUNTY TREASURER

Laura B. Fitzpatrick
Treasurer

TO: LES LEE SHELL, Chief Administrative Officer
FROM: ADELLA LOGAN, Delinquent Tax Collector
SUBJECT: NRS 361.603 Entity Request for 139-27-210-070
DATE: February 17, 2022

The Treasurer's office has received a request, per NRS 361.603, from the **City of Las Vegas** for the following property. Attached you will find the required packet of information for review and possible Board of County Commissioners Agenda item.

APN number: **139-27-210-070**
Property Address: **1021 F St**, Las Vegas, NV
County Commission District: **D – William McCurdy**
Tax District: **214**
Current Ownership: **WATSON, MICHAEL P**

Date Treasurer Trustee Deed Recorded: **06/12/2012**
Date of last property tax payment received: **04/07/2009**
Are consistent partial payments being received for this property? **No**
Has parcel been included in a prior Trustee Auction and not sold? **Yes**
Could parcel be included in upcoming Trustee Auction? **Yes**

Any pertinent information from Treasurer Trustee File: **Large City of Las Vegas Abatement & Las Vegas Sewer**

If you need any additional information please do not hesitate to contact me at 455-4338 or all@clarkcountynv.gov



**LAS VEGAS
CITY COUNCIL**

CAROLYN G. GOODMAN
Mayor

STAVROS S. ANTHONY
Mayor Pro Tem

MICHELE FIORE
CEDRIC CREAR
BRIAN KNUDSEN
VICTORIA SEAMAN
OLIVIA DIAZ

JORGE CERVANTES
City Manager

DEPARTMENT
**OPERATIONS &
MAINTENANCE**

JERRY WALKER, DIRECTOR

February 16, 2022

Clark County Treasurer's Office
500 S. Grand Central Parkway
Las Vegas, NV 89155

Subject Properties: APN's 139-27-811-015 (715 Bell Drive), 139-27-811-016 (721 Bell Drive), 139-27-310-023 (808 G St.), 139-22-310-027 (604 Kasper Ave), 139-27-210-070 (1021 F. St), 139-27-111-025 (204 W. Van Buren)

Pursuant to NRS 361.603, the City of Las Vegas is requesting to acquire the subject properties referenced above, in the amount of the past due taxes owed and any applicable fees. The City desires to acquire the parcels for the purposes of area revitalization pursuant to the Historic Westside School Master Plan and the future expansion of the Downtown corridor.

Please present this request to your Board of Commissioners for their approval. Should you have any questions or need additional information regarding this request, please contact my office by e-mail at tboyce@lasvegasnevada.gov or by phone at 702-229-1022.

Thank you,



Teresa M. Boyce
Real Estate Manager
Dept. of Operations & Maintenance

TB/cs

CITY HALL

495 S. MAIN ST.
LAS VEGAS, NV 89101
702.229.6011 | VOICE
711 | TTY



cityoflasvegas
lasvegasnevada.gov

Briana Johnson, Assessor

PARCEL OWNERSHIP HISTORY

ASSESSOR DESCRIPTION
H F M & M ADD PLAT BOOK 1 PAGE 47 PT LOT 7 BLOCK 18

CURRENT PARCEL NO.	CURRENT OWNER	RECORD DOC NO.	RECORD DATE	VESTING	TAX DIST	EST SIZE	COMMENTS
139-27-210-070	WATSON MICHAEL P	20060719:00330	6/12/2012	NS	214	.13 AC	TAX DEED- 20120612:02610

PARCEL NO.	PRIOR OWNER(S)	%	RECORD DOC NO.	RECORD DATE	VESTING	TAX DIST	EST SIZE	COMMENTS
139-27-210-070	WATSON MICHAEL P		20060719:00330	07/19/2006	NS	200	SUBDIVIDED LOT	
139-27-210-070	JACKSON RONALD JAMES		20060517:00182	05/17/2006	NS	200	SUBDIVIDED LOT	
139-27-210-070	JACKSON'S RENTAL HOUSING _____ JACKSON RONALD JAMES		20060517:00181	05/17/2006	NS	200	SUBDIVIDED LOT	
139-27-210-070	JACKSON'S RENTAL HOUSING _____ JACKSON DEANGELO		20051021:01078	10/21/2005	NS	200	SUBDIVIDED LOT	
139-27-210-070	JACKSON RONALD J & DEANGELO _____ JACKSON RONALD J		20051021:01069	10/21/2005	NS	200	SUBDIVIDED LOT	
139-27-210-070	JACKSON RONALD J _____ JACKSON VALERIE JEAN & DEANGELO		20040629:06276	06/29/2004	JT	200	SUBDIVIDED LOT	
139-27-210-070	JACKSON RONALD J		20031118:01076	11/18/2003	NS	200	SUBDIVIDED LOT	L- 20040507:2120
139-27-210-070	JACKSON RONALD J & VALERIE J		20030411:00359	04/11/2003	JT	200	SUBDIVIDED LOT	
139-27-210-070	HOUSEHOLD FINANCE REALTY CORP NV		20030107:00150	01/07/2003	NS	200	SUBDIVIDED LOT	
Entity Request for Transfer of Parcel 139-27-210-070								

139-27-210-070	JOHNSON JERALDINE	19940617:01456	06/17/1994	NS	200	SUBDIVIDED LOT	
139-27-210-070	JOHNSON GERALDINE	19880331:00029	03/31/1988	NS	200	SUBDIVIDED LOT	CC-940217:962
010-552-013	JOHNSON HENRY & GERALDINE	0351:0283687	04/02/1962	JT	200	SUBDIVIDED LOT	
010-552-013	JOHNSON HENRY & GERALDINE	0351:0283687	04/02/1962		200	SUBDIVIDED LOT	INITIAL