

CLARK COUNTY BOARD OF COMMISSIONERS
ZONING / SUBDIVISIONS / LAND USE
AGENDA ITEM

Petitioner: Sami Real, Director, Department of Comprehensive Planning

Recommendation: ORD-25-900573: Introduce an ordinance to consider adoption of a Development Agreement with Richmond American Homes of Nevada, Inc for a single-family residential development on 8.59 acres, generally located south of Cactus Avenue and east of Quarterhorse Lane within Enterprise. JJ/dw (For possible action)

FISCAL IMPACT:

None by this action.

BACKGROUND:

The Board of County Commissioners (Board) approved a land use application WS-24-0134 for a single-family residential development on 8.59 acres, generally located south of Cactus Avenue and east of Quarterhorse Lane within Enterprise. Conditions of approval included the developer and/or owner entering into a Development Agreement prior to any permits being issued in order to provide their fair-share contribution towards public infrastructure necessary to provide service in the southwest portion of the Las Vegas Valley.

In accordance with the provisions of Section 278.0203 of the Nevada Revised Statutes, a Development Agreement must be approved by ordinance.

Staff recommends the Board set a public hearing for September 17, 2025.

Cleared For Agenda
09/03/25

BILL NO. _____

SUMMARY - An ordinance to adopt the Development Agreement with Richmond American Homes of Nevada, Inc for a single-family residential development on 8.59 acres, generally located south of Cactus Avenue and east of Quarterhorse Lane within Enterprise.

ORDINANCE NO. _____
(of Clark County, Nevada)

AN ORDINANCE TO ADOPT THE DEVELOPMENT AGREEMENT WITH RICHMOND AMERICAN HOMES OF NEVADA, INC FOR A SINGLE-FAMILY RESIDENTIAL DEVELOPMENT ON 8.59 ACRES, GENERALLY LOCATED SOUTH OF CACTUS AVENUE AND EAST OF QUARTERHORSE LANE WITHIN ENTERPRISE, AND PROVIDING FOR OTHER MATTERS PROPERLY RELATED THERETO.

THE BOARD OF COUNTY COMMISSIONERS OF THE COUNTY OF CLARK, STATE OF NEVADA, DOES HEREBY ORDAIN AS FOLLOWS:

SECTION 1. In accordance with the provisions of Section 278.0203 of the Nevada Revised Statutes and Chapter 30.06 of the Clark County Code, the Development Agreement with Richmond American Homes of Nevada, Inc for a single-family residential development on 8.59 acres, generally located south of Cactus Avenue and east of Quarterhorse Lane within Enterprise, is hereby adopted.

SECTION 2. If any section of this ordinance or portion thereof is for any reason held invalid or unconstitutional by any court of competent jurisdiction, such holding shall not invalidate the remaining parts of this ordinance.

SECTION 3. All ordinances, parts of ordinances, chapters, sections, subsections, clauses, phrases or sentences contained in the Clark County Code in conflict herewith are hereby repealed.

SECTION 4. This ordinance shall take effect and be in force from and after its passage and the publication thereof by title only, together with names of the County Commissioners voting for or against its passage, in a newspaper published in and having a general circulation in Clark County, Nevada, at least once a week for a period of two (2) weeks and shall be effective on and from the fifteenth day after passage.

PROPOSED on the _____ day of _____, 2025

INTRODUCED by: _____

PASSED on the _____ day of _____, 2025

VOTE:

AYES: _____

NAYS: _____

ABSTAINING:

ABSENT:

BOARD OF COUNTY COMMISSIONERS
CLARK COUNTY, NEVADA

By: _____
TICK SEGERBLOM, Chair

ATTEST:

Lynn Marie Goya, County Clerk

This ordinance shall be in force and effect from and after the _____ day
of _____ 2025.

APN(s): **176-32-101-008 & -009**
Please Return to: Sami Real
Comprehensive Planning Department
1st Floor, Clark County Government Center
500 South Grand Central Parkway
Las Vegas, Nevada 89155

DEVELOPMENT AGREEMENT

BETWEEN

THE COUNTY OF CLARK

AND

RICHMOND AMERICAN HOMES OF NEVADA, INC.

FOR

CACTUS & QUARTERHORSE

ORD-25-900573

DEVELOPMENT AGREEMENT

THIS DEVELOPMENT AGREEMENT (the "Agreement") is made and entered into by and between the *County of Clark, State of Nevada* (hereinafter referred to as the "County") and **RICHMOND AMERICAN HOMES OF NEVADA, INC** the Owner of the real property described on Exhibit "A" attached hereto (hereinafter referred to as the "Owner") and incorporated herein by reference.

SECTION 1 – DEFINITIONS

1.01 Definitions. For all purposes of this Agreement, except as otherwise expressly provided or unless the context otherwise requires, the following terms shall have the following meanings:

- (a) "Agreement" has the meaning assigned to it in the first paragraph hereof. Agreement at any given time includes all addenda and exhibits incorporated by reference and all amendments, which have become effective as of such time.
- (b) "Applicable Rules" means the specific code, ordinances, rules, regulations and official policies of the County as adopted and in force at the time of permit issuance or map recordation and as amended from time to time, regarding planning, zoning, subdivisions, timing and phasing of development, permitted uses of the Subject Property, density, design, and improvement standards and specifications applicable to the Project, including the Public Facilities Needs Assessment Report, and the fees incorporated herein, except that:
 - (1) The fees required in the County Code specifically for the Major Projects shall *not* apply to the Project, unless and until the parties agree that the development of the Project will be processed as a Major Project;
and
 - (2) The zoning established by the Concurrent Approvals will not be amended or modified during the term of this Agreement without Owner's prior written approval.
- (c) "Best Efforts" means, in the case of any contingent obligation of County or Owner, that the party so obligated will make a good faith effort to accomplish the stated goal, task, project or promised performance, provided such term does not imply a legal obligation to take any specific action if:
 - (i) In the case of a County obligation, such action would, in the reasoned opinion of the County Commission, be imprudent given competing public needs and projects; or
 - (ii) In the case of an Owner obligation, such action would, in the reasoned opinion of the Owner, be commercially unreasonable.

In either case, upon request, the responsible party shall give written notice to the other party that it has considered such contingent obligation and the reason for its decision not to perform.

- (d) "Builder" means any person or entity, which constructs final improvements (other than off-site improvements or infrastructure) with respect to a subdivision or parcel of the Subject Property.
- (e) "Code" means the Clark County Code, including all rules, regulations, standards, criteria, manuals and other references adopted herein.
- (f) "Concurrent Approvals" means the zoning, land use or map approvals and authorizations, relating to the Subject Property, together with the applicable conditions, as granted by the County Commission, including without limitation those approvals and conditions of

approval per **WS-24-0134**, the Agenda Sheet, Notice of Final Action and agenda map attached hereto as Exhibit "C" and incorporated herein by this reference.

- (g) "County" means the County of Clark, State of Nevada together with its successors and assigns.
- (h) "County Commission" means the Board of County Commissioners or Planning Commission of the County of Clark, State of Nevada.
- (i) "County Master Plan" means the comprehensive plan adopted by the County Commission in 1983 and all amendments thereto including, but not limited to, all adopted land use, development guides and elements, including the land use and development guide and the general plan map for unincorporated portions of the Las Vegas Valley adopted by the County Commission on January 24, 1974, except as amended by the adoption of more recent plans in effect as of the Effective Date.
- (j) "Development Agreement Ordinance" means an ordinance adopted per Chapter 30.06 of the Clark County Unified Development Code (Title 30) along with any other Chapters of the Clark County Code that are relevant to the Development Agreement being considered.
- (k) "Effective Date" means the date, on or after the adoption by the County Commission, of an ordinance approving execution of this Agreement whereas the Agreement has been executed and signed by both parties, that this Agreement is recorded in the Office of the County Recorder of Clark County, Nevada.
- (l) "NDOT" means Nevada Department of Transportation.
- (m) "NRS" means Nevada Revised Statutes.
- (n) "PFNA" means the Southwest Las Vegas Valley Public Facilities Needs Assessment Report, dated December 1, 2000, incorporated herein by this reference and approved by the County Commission on January 2, 2001.
- (o) "Project" means the Subject Property and the proposed development of the Subject Property described in this Agreement.
- (p) "Subject Property" means that certain real property, which Owner owns or has the right to acquire, located in the County and more particularly described on Exhibit "A".
- (q) "Term" means the term of this Agreement together with any extension agreed upon pursuant to Section 7.02 hereof.

SECTION 2 – RECITAL OF PREMISES, PURPOSE AND INTENT

2.01 Recitals. This Agreement is predicated upon the following facts and findings:

- (a) Statutory Authorization. The County is authorized, pursuant to NRS §278.0201 through 278.0207, inclusive, to enter into binding Development Agreements with persons having a legal or equitable interest in real property to establish long range plans for the development of such property.
- (b) Ownership Interest. Owner represents that it has, will acquire, or has the right to acquire, fee title ownership of the Subject Property.
- (c) County Authorization, Hearing and Ordinance. All preliminary processing with regard to the Project has been duly completed in conformance with all applicable laws, rules and regulations. The County Commission, having given notice as required by law, held a public hearing on Owner's application seeking approval of the form of this Agreement and the execution hereof by the County. At the described meeting, the County Commission found that this Agreement is consistent with the County's plans, policies and regulations, including the County Master Plan, that the Agreement meets the requirements of Title 30 of the Code, and that the execution hereof by and on behalf of the County is in the public interest and is lawful in all respects. During the same meeting at which the public hearing was held, the County Commission adopted the Ordinance approving this Agreement and authorizing the execution hereof by duly constituted officers of the County. Said ordinance was scheduled to be effective two weeks after adoption. County agrees to record a certified copy of the ordinance as required by NRS §278.0207.
- (d) County Intent. The County desires to enter into this Agreement in conformity with the requirements of NRS, and as otherwise permitted by law, and this Agreement to provide for public services; public uses and urban infrastructure; to promote the health, safety and general welfare of the County and its inhabitants; to minimize uncertainty in planning for and securing orderly development of the Project and surrounding areas; to insure attainment of the maximum efficient utilization of resources within the County at the least economic cost to its citizens; and to otherwise achieve the goals and purposes for which the State statute and County ordinance authorizing Development Agreements were enacted.
- (e) Owner Intent. In accordance with the legislative intent evidenced by NRS §278.0201 through §278.0207, inclusive, authorizing Development Agreements and the intent of the County in adopting an ordinance allowing Development Agreements, Owner wishes to obtain reasonable assurances that Owner may develop the Project in accordance with the conditions established in this Agreement. Owner acknowledges that there are insufficient public services, which includes facilities and infrastructure, existing or planned at this time. In order to develop the Subject Property, Owner is willing to enter into this Development Agreement in order to pay Owner's fair share of the costs to provide certain public services, facilities, and infrastructure in the area of this Project. Owner further acknowledges that this Agreement was made a part of the County Record at the time of its approval by the County Commission and that the Owner agrees without protest to the requirements, limitations, or conditions imposed by this Agreement and the Concurrent Approvals.
- (f) Acknowledgment of Uncertainties. The parties acknowledge that circumstances beyond the control of either party could defeat their mutual intent that the Project be developed in the manner contemplated by this Agreement. Among such circumstances is the unavailability of

water or other limited natural resources, federal regulation of air and water quality, and similar conditions. Owner recognizes that water shortages could affect the County's ability to perform its obligations hereunder. Owner further acknowledges and agrees this Agreement does not relieve the Owner from compliance with existing, changed, modified or amended rules regulations, laws, ordinances, resolutions, fees codes, etc., of other governmental agencies. Such rules, regulations, laws, ordinances, resolutions, fees, codes, etc. of governmental entities must be complied with by the Owner and are not locked in nor a part of this Agreement. It is not the intent of the parties nor shall this Section be construed as excusing the County of any obligation hereunder or depriving Owner of any right under this Agreement, which can be performed.

- (g) Provision of Water and Sewer Service. Owner clearly understands and agrees that, amongst other requirements, water commitment and sanitary sewer system development approval must be obtained from the proper governmental entities namely the Las Vegas Valley Water District and the Clark County Water Reclamation District. Fees and services for such commitments and systems are established by said governmental entities and must be paid and complied with by the Owner in accordance with said governmental entities requirements as amended from time to time. This Agreement or the County does not guarantee or provide the provision of water and sewer services.

2.02 Incorporation of Recitals. The foregoing recitals shall be deemed true and correct in all respects with respect to this Agreement and shall serve as the basis for the interpretation of this Agreement.

2.03 Permitted Uses, Density, Height and Size of Structures. Pursuant to NRS §278.0201 and the Code, this Agreement must set forth the maximum height and size of structures to be constructed on the Subject Property, the density of uses and the permitted uses of the land. County agrees the Project may be developed to the density and with the land uses set forth in the Land Use and Development Guide/Plan, along with the development standards set forth in the Concurrent Approvals and the Applicable Rules.

SECTION 3 – DEVELOPMENT OF THE PROJECT

3.01 Time for Construction and Completion of the Project. Subject to the terms of this Agreement and Applicable Rules, Owner shall have discretion as to the time of commencement, construction, phasing, and completion of any and all development of the Project. Nothing herein shall be construed to require the Owner to develop the Project or any part thereof.

3.02 Reliance on Concurrent Approvals and Applicable Rules. County hereby agrees that Owner will be permitted to carry out and complete the entire Project in accordance with the uses and densities set forth in the Concurrent Approvals subject to the terms and conditions of this Agreement and the Applicable Rules. Pursuant to the terms of this Agreement and subject to Owner's infrastructure obligations described in this Agreement, the development of the Project may proceed.

3.03 Air Quality Conformity. Owner acknowledges County has adopted an air quality plan and agrees to comply with the applicable provisions thereof, including any state and federal rules and regulations.

3.04 Dust Mitigation. Owner will educate Builders and contractors within the Project of the applicable rules of the Clark County Department of Air Quality & Environmental Management with respect to dust mitigation and will encourage compliance therewith.

3.05 Water Conservation. Owner agrees to encourage water conservation in the Project. Owner agrees to design any open space using the best available, water conserving techniques, including but not

limited to proper soil preparation and water conserving irrigation systems and equipment. Landscaping adjacent to public streets shall be limited to water conserving plant materials.

- 3.06 Temporary Storm Water Construction Permit. Owner agrees to educate Builders and contractors within the Project on the requirements for a Temporary Storm Water Construction Permit issued from the Nevada Division of Environmental Protection (NDEP).

SECTION 4 – PUBLIC FACILITIES

- 4.01 Public Facilities. Owner agrees that prior to issuance of any building permit for a single family dwelling, multiple family dwelling, retail, office, industrial or hotel use in the Project, they will pay the fees as set forth in the Public Facilities Chart below, hereinafter referred to as Chart 4.01-A, except as modified by this Section 4.01.

In addition, the fees set forth in Chart 4.01-A below may be increased or decreased from time to time during the term of this Agreement if the modified fees are uniformly applied to all development and construction within the Public Facilities Needs Assessment area. The County and Owner agree that any fee modifications shall be applied only for building permits not yet issued. Owner and the County will not be entitled to any payment or reimbursements for fees paid for building permits issued prior to any such fee modification.

CHART 4.01-A PUBLIC FACILITIES CHART			
Type Of Development	Infrastructure Category		Total Per Unit
	Parks	Public Safety	
Single Family Dwelling Unit (per dwelling unit)	\$ 627.58	\$ 1,060.80	\$ 1,688.39
Multi Family Dwelling Unit (per dwelling unit)	\$ 627.58	\$ 1,040.11	\$ 1,667.70
Retail (per square foot gross floor area)	N/A	\$ 0.71	\$ 0.71
Office (per square foot gross floor area)	N/A	\$ 0.79	\$ 0.79
Industrial (per square foot gross floor area)	N/A	\$ 0.47	\$ 0.47
Hotel (per room)	N/A	\$ 1,062.52	\$ 1,062.52

- 4.02 Parks. In addition to the fees in Chart 4.01-A above, Owner agrees that this development is subject to the Residential Construction Tax if required by Chapter 19.05 of the Clark County Code.
- 4.03 Traffic Study. Owner shall prepare and submit to the County (and NDOT if applicable) a Traffic Study (if required) acceptable to the County (and NDOT if applicable) for the Subject Property prior to submittal of any final map for technical review, or prior to County issuance if any grading or building permits; whichever occurs first, and Owner agrees to comply with said Study as approved by the County. Any modification to the Traffic Study must be approved by the Director of the Department of Public Works.

In addition to the fees in Chart 4.01-A above, Owner agrees to construct at its sole cost and expense and dedicate to the County (or NDOT if applicable) any such roadway and traffic improvements identified in the Traffic Study as approved with conditions by the County (and NDOT if applicable), which are necessary for the Subject Property or for the mitigation of any traffic impacts caused by the development of the Subject Property.

Each facility must be built in the manner prescribed by the Code, NRS, and in accordance with the, “Uniform Standard Drawings for Public Works Construction, Off-Site Improvements, Clark County Area, Nevada”, as amended by the Concurrent Approvals as approved by the County, and the State’s Design Manual prior to issuance of any building permits for the area impacted by the facilities, as identified in the Traffic Study as approved with conditions by the County (an NDOT if applicable).

Nothing herein shall be construed to require Owner to construct the applicable traffic improvements if Owner does not develop the impacted area. Owner acknowledges it shall be responsible for all public and private roadway construction (if applicable), utility installations and modifications, lighting, traffic control equipment and signage, and aesthetic improvements relating to the development.

- 4.04 Drainage Study. Owner shall prepare and submit to the County a Drainage Study, if required by the Clark County Department of Public Works, acceptable to the County for the Subject Property prior to recording any final map or the issuance of any grading and/or building permits. In addition to the fees in Chart 4.01-A above, Owner agrees to construct at its sole cost and expense and dedicate to the County such flood and drainage facilities identified in the Drainage Study which are necessary for the flood protection of the Subject Property or for the mitigation of any downstream flood impacts caused by the development of the Subject Property.

Each facility must be built, in the manner prescribed by Code, prior to issuance of any grading and/or building permits for the area impacted by the facilities as identified in the approved Drainage Study in accordance with Code. Notwithstanding any other provision in this section no grading or building permit shall be issued in any area not protected by the drainage facilities identified in the approved Drainage Study.

SECTION 5 – REVIEW AND DEFAULT

- 5.01 Frequency of Reviews. As required by NRS §278.0205 and the Development Agreement Ordinance, at least once every twenty-four (24) months during the Term of this Agreement, Owner shall provide and County shall review in good faith a report submitted by Owner documenting the extent of Owner's and County's material compliance with the terms of this Agreement during the preceding twenty-four (24) months. If at the time of review an issue not previously identified in writing is required to be addressed, the review, at the request of either party, shall be continued to afford sufficient time for response.

- 5.02 Opportunity to be Heard. County and Owner shall be permitted an opportunity to be heard orally and in writing before the County Commission regarding their performance under this Agreement in the manner set forth in Development Agreement Ordinance.

- 5.03 Procedures in the Event of Noncompliance. In the event of any noncompliance with any provision of this Agreement, the party alleging such noncompliance shall deliver to the other in writing a courtesy notice, not less than thirty (30) calendar days prior to declaring a default under this Agreement. The time of notice shall be measured from the date of post mark which may be sent by regular mail.

The courtesy notice shall state the reason for noncompliance, any action necessary to correct the noncompliance, specify the nature of the alleged default and, where appropriate, the manner and period of time in which the noncompliance may be satisfactorily corrected. During the period of time the default letter is pending, the party alleged to be in default shall not be considered in default for the purposes of termination or institution of legal proceedings. If the default is corrected, then no default shall exist and the noticing party shall take no further action. If the default is not corrected within thirty (30) calendar days, the following courses of action shall apply:

- (a) County Procedures

- (i) Intent to Remedy Noncompliance. After proper notice and the expiration of the above-referenced periods for correcting the alleged default, the Director of

Development Services, or his or her designee, may do one or both of the following options:

- (1) Immediately direct County staff to recommend that all future zoning, land use, and mapping applications within the Project be conditioned so that the building permits to be issued as a result of those approvals shall not be issued until the default is corrected, or;
 - (2) Issue a letter providing notice of County's intent to set the matter for hearing before the County Commission. The letter shall notify Owner of the action taken. In the event the County selects this option, County shall give Owner at least seven (7) business days notice to correct the default before the matter is scheduled for a hearing. The letter notifying Owner of the hearing shall contain the intended hearing date. The seven (7) business days will be measured from the date of the certified mailing of the notice.
 - (ii) Hearing Schedule. If the default is not corrected within the time specified above, the matter shall be scheduled and noticed as required by law for consideration and review by the County Commission on the next available Commission zoning agenda.
 - (iii) Review by County Commission. Following consideration of the evidence presented before the County Commission and a finding based on substantial evidence that a default has occurred by Owner and the default remains uncorrected, the County Commission may authorize the suspension of building permits within the Project or may amend or terminate this Agreement. Termination shall not in any manner rescind, modify, or terminate any Vested Right in favor of Owner, existing or received, as of the date of the termination. Owner shall have twenty-five (25) calendar days after the date of notice of the County Commission's decision is filed with the Clark County Clerk, Commission Division, to institute legal action pursuant to Sections 5.05 and 5.06 hereof, to determine whether the County Commission abused its discretion in determining whether a default existed and remained uncorrected.
- (b) Owner Procedures
- (i) After proper notice and the expiration of the above-referenced periods for correcting the alleged default, Owner may issue a letter requesting a hearing before the County Commission for review of the alleged default. Upon receipt of the letter, County shall schedule an item to consider the alleged default on the next available Commission zoning agenda.
 - (ii) Review by County Commission. Following consideration of the evidence presented before the County Commission and a finding based on substantial evidence that a default has occurred by County and remains uncorrected, the County Commission shall direct County staff to correct the default. Owner shall have twenty-five (25) calendar days after the date of notice of the County Commission's decision is filed with the Clark County Clerk, Commission Division, to institute legal action pursuant to this Section hereof to determine whether the County Commission abused its discretion in determining whether a default existed and remained uncorrected.
- (c) Waiver. Failure or delay in giving any notice provided for herein shall not constitute a waiver of any default. Except as otherwise expressly provided in this Agreement, any failure or delay by any party in asserting any of its rights or remedies in respect to any default shall not operate as a waiver of any default or of any such rights or remedies, or deprive such party of its right to institute and maintain any actions or proceeding which it may deem necessary to protect, assert, or enforce any of its right or remedies.

(d) Notices. All notices provided for herein shall be sent to and in the manner provided in Section 7.08 of this Agreement.

5.04 Option to Terminate. After proper notice and the expiration of the above-referenced period for correcting the alleged default, the party alleging the default shall give notice of intent to amend or terminate this Agreement pursuant to NRS §278.0205 (the "Notice of Intent"), with notices sent in the manner provided by Section 7.08 of this Agreement. Following any such Notice of Intent, the matter shall be scheduled and noticed as required by law for consideration and review by the County Commission.

5.05 Unavoidable Delay or Default, Extension of Time for Performance. Neither party hereunder shall be deemed to be in default, and performance shall be excused, where delays or defaults are caused by war, acts of terrorism, insurrection, strikes, walkouts, riots, floods, earthquakes, fires, casualties, acts of God, restrictions imposed or mandated by governmental entities, failure of governmental agencies (other than County) to perform acts or deeds necessary for the performance of this Agreement, enactment of conflicting state or federal laws or regulations, new or supplementary environmental regulations, litigation, or similar matters beyond the control of the parties. If written notice of any such delay is given to County within thirty (30) calendar days after the commencement thereof, an automatic extension of time, unless otherwise objected to by County within ten (10) business days of such written notice, shall be granted coextensive with the period of the enforced delay, or longer as may be required by circumstances or as may be subsequently agreed to between County and Owner.

5.06 Institution of Legal Action. The County and Owner agree that the County would not have entered into this Agreement if it were liable for damages under or with respect to this Agreement. Accordingly, the County and the Owner may pursue any remedy at law or equity available for breach, except that neither the Owner nor the County shall be liable to the other or to any other person or entity for any monetary damages whatsoever. Prior to the institution of any legal action, the party seeking legal action must give the thirty (30) day notice of default as set forth in Section 5.03. Following such notice, a public hearing must be held by the County Commission where the allegations will be considered and a decision regarding their merits will be reached. Any judicial review of the County Commission's decision or any legal action taken pursuant to this Agreement will be heard by a Court under the standard review appropriate to Court review of zoning actions, and the decision of the County Commission shall be overturned or overruled if its decision is clearly arbitrary and capricious. Judicial review of the decision of the County Commission shall be limited to the evidence presented to the County Commission at the public hearing. If a party desires to present new or additional evidence to the Court, such party may petition the Court to remand the matter to the County Commission to consider the additional or new evidence. Jurisdiction for judicial review or any judicial action under this Agreement shall rest exclusively with the Eighth Judicial District Court, State of Nevada.

5.07 Applicable Laws. This Agreement shall be construed and enforced in accordance with the law of the State of Nevada.

SECTION 6 – CONFLICTING LAWS

6.01 Conflicting State or Federal Rules. In the event that any conflicting state or federal laws or regulations enacted after the Effective Date prevent or preclude compliance with one or more provisions of this Agreement or require changes in plans, maps or permits approved by the County,

this Agreement shall remain in full force and effect as to those provisions not affected, and the conflicting laws or regulations shall not be applied retroactively, and:

- (a) Notice and Copies. Either party, upon learning of any such matter, will provide the other party with written notice thereof and provide a copy of any such law, regulation or policy or an account of any such action or inaction together with a statement of how any such matter conflicts with the provisions of this Agreement; and
- (b) Modification Conferences. The parties shall, within thirty (30) calendar days of the notice referred to in the preceding subsection, meet and confer in good faith and attempt to modify this Agreement to bring it into compliance with any such federal or state law or regulation, or accommodate any such action or inaction.

6.02 County Commission Hearings. In the event the County believes that an amendment to this Agreement is necessary pursuant to this Section 6 due to the effect of any federal or state law or regulation, the proposed amendment shall be scheduled for hearing before the County Commission. The County Commission shall determine the exact nature of the amendment or suspension necessitated by such federal or state law or regulation or action or inaction. Owner shall have the right to offer oral and written testimony at the hearing. Any suspension or modification ordered by the County Commission pursuant to such hearing is subject to judicial review as set forth in Section 5.06. The parties agree that any matter submitted for judicial review shall be subject to expedited review in accordance with Rule 2.15 of the Eighth Judicial District Court of the State of Nevada.

6.03 Cooperation in Securing Permits. The County shall use its Best Efforts to cooperate with Owner in securing any County permits, licenses or other authorizations which may be required as a result of any amendment or suspension resulting from actions initiated under this Section 6. Owner will be responsible to pay all applicable fees in connection with securing of the permits.

SECTION 7 – GENERAL PROVISIONS

7.01 Enforcement and Binding Effect. Subject to the limitations of NRS §278, this Agreement is enforceable by either party in accordance with its terms notwithstanding any change (which, except for this Agreement, would otherwise be applicable) in any of the Applicable Rules. Nothing in this Agreement shall prevent the County from increasing "cost based fees" which are deemed to be administrative fees for issuance of land use approvals, building permits, plan checks, or inspections which are based upon actual costs to the County and which are uniformly applied to all development and construction subject to the County's jurisdiction. "Cost based fees" do not include the fees addressed in Section 4.01 of this Agreement.

7.02 Duration of Agreement. The Term of this Agreement shall commence upon the Effective Date and shall expire on the date the land use application expires or upon the eighth (8th) anniversary of the Effective Date, or when all obligations hereunder are satisfied, whichever occurs earliest, unless extended by written agreement executed by County and Owner.

7.03 Assignment.

- (a) Transfer Not to Relieve Owner of its Obligation. Except as expressly provided herein, no assignee or transferee of any portion of the Project within the area covered by a recorded subdivision map shall be subject to the obligations of Owner as to the portion of the Project so assigned or transferred nor be deemed to have assumed all such obligations, and such assignment or transfer shall not relieve Owner of its obligation as to the assigned or transferred portion of the Project.

- (b) Transfer to an Affiliate of Owner. The rights of Owner under this Agreement may be freely transferred or assigned to any entity, partnership, or corporation, which Owner controls, or in which Owner has a controlling interest, or which controls Owner; provided, such entity shall assume in writing all obligations of Owner hereunder.
- (c) Third Party Assignment. The rights and obligations of Owner under this Agreement may be freely transferred or assigned to a third party not affiliated with Owner, provided such third party assumes in writing all obligations of Owner hereunder as to the assigned or transferred portion of the Project along with a copy of the sale, transfer, conveyance, or assignment agreement wherein the third party assumes the obligations of the Owner. Upon any such assignment hereunder, the Owner shall be relieved of all obligations and liabilities under or in connection with this agreement. In connection with the conveyance of any portion of the property, Owner shall provide County with written notice of any sale, transfer, conveyance or assignment of any unimproved portion of the Project.
- (d) Financial Transactions. Owner has full discretion and authority to transfer, assign or encumber the Project or portions thereof in connection with financing transactions, without limitation on the size or nature of any such transaction, the amount of land involved or the use of the proceeds therefrom, and may enter into such transaction at any time and from time to time without permission of or notice to County.

7.04 Amendment or Cancellation of Agreement. Except as otherwise permitted by NRS §278.0205 and Section 5 of this Agreement, this Agreement may be amended from time to time or canceled only upon the mutual written agreement of the parties hereto.

7.05 Indemnity; Hold Harmless. Except as expressly provided in this Agreement, Owner shall hold County, its officers, agents, employees, and representatives harmless from liability for damage or claims for damage for personal injury, including death and claims for property damage which may arise from the direct or indirect operations of Owner or those of its contractors, subcontractors, agents, employees, or other persons acting on Owner's behalf which relate to the development of the Project. Owner agrees to and shall defend County and its officers, agents, employees, and representatives from actions for damages caused or alleged to have been caused by reason of Owner's activities in connection with the development of the Project. Owner agrees to indemnify, hold harmless, and provide and pay all costs for a defense for County in any legal action filed in a court of competent jurisdiction by a third party challenging the validity of this Agreement. The provisions of this Section shall not apply to the extent such damage, liability, or claim is solely caused by the intentional or negligent act of County, its officers, agents, employees, or representatives.

7.06 Binding Effect of Agreement. Subject to Section 7.03 hereof, the burdens of this Agreement bind, and the benefits of this Agreement inure to the parties' respective successors in interest.

7.07 Relationship of Parties. It is understood that the contractual relationship between County and Owner is such that Owner is an independent contractor and not an agent of County for any purpose.

7.08 Notices. All notices, demands and correspondence required or provided for under this Agreement shall be in writing and delivered in person or sent by overnight courier or mailed by certified mail postage prepaid, return receipt requested. Notices shall be sent to the address on file to Owner and/or Applicant, as shown on "Exhibit B" and the Comprehensive Planning Department and Office of the District Attorney-Civil Division addressed as follows:

To County: COUNTY OF CLARK
Department of Comprehensive Planning, Current Planning Division
Clark County Government Center
500 South Grand Central Parkway, 1st Floor
P.O. Box 551741
Las Vegas, NV 89155-1741

With a Copy to: COUNTY OF CLARK
OFFICE OF THE DISTRICT ATTORNEY-CIVIL DIVISION
Clark County Government Center
500 South Grand Central Parkway, 5th Floor
P.O. Box 552215
Las Vegas, Nevada 89155-2215

Either party may change its address by giving notice in writing to the other and thereafter notices, demands and other correspondence shall be addressed and transmitted to the new address. Notices given in the manner described shall be deemed delivered on the day of personal delivery or the delivery date by overnight courier or mail is first attempted.

- 7.09 Entire Agreement. This Agreement constitutes the entire understanding and agreement of the parties. This Agreement integrates all of the terms and conditions mentioned herein or incidental hereto and supersedes all negotiations or previous agreements between the parties with respect to all or any part of the subject matter hereof.
- 7.10 Waivers. All waivers of the provisions of this Agreement must be in writing and signed by the appropriate officers of the County or Owner, as the case may be.
- 7.11 Recording Amendments. Promptly after the Effective Date, an executed original of this Agreement shall be recorded in the Official Records of Clark County, Nevada. All amendments hereto must be in writing signed by the appropriate officers of County and Owner in a form suitable for recordation in the Official Records of Clark County, Nevada. Upon the completion of performance of this Agreement or its earlier revocation or termination, a statement evidencing said completion or revocation signed by appropriate officers of County and Owner shall be recorded in the Official Records of Clark County, Nevada.
- 7.12 Release. Each unit within the Subject Property shall be automatically released from the encumbrance of this Agreement without the necessity of executing or recording any instrument of release upon the issuance of an Occupancy Permit for the building in which the unit is located.
- 7.13 Headings, Exhibits, Cross-references. The headings and captions used in this Agreement are for convenience and ease of reference only and shall not be used to construe, interpret, expand or limit the terms of this Agreement. All exhibits attached to this Agreement and the recitals at the front of this Agreement are incorporated herein by the references thereto contained herein. Any term used in an exhibit hereto shall have the same meaning as in this Agreement unless otherwise defined in such exhibit. All references in this Agreement to Sections and Exhibits shall be to Sections and Exhibits of or to this Agreement, unless otherwise specified.
- 7.14 Severability of Terms. If any term or other provision of this Agreement is held to be invalid, illegal or incapable of being enforced by any rule of law or public policy, all other conditions and provisions of this Agreement shall nevertheless remain in full force and effect, provided that the invalidity, illegality or unenforceability of such term does not materially impair the parties' ability to consummate the transactions contemplated hereby. If any term or other provision is invalid, illegal

or incapable of being enforced, the parties hereto shall, if possible, amend this Agreement so as to affect the original intention of the parties.

- 7.15 Voluntary Agreement. Owner acknowledges that they had the option of conducting their own public facilities needs assessment study, but instead voluntarily chose to accept the findings, conclusions and fee schedule contained within the County PFNA defined in Section 1.01(n) of this Agreement. Owner further acknowledges and agrees that it voluntarily, willingly and without protest and duress freely enters into this Agreement and accepts the terms and conditions herein.
- 7.16 No Third Party Beneficiary Rights. This Agreement shall inure solely to the benefit of each party hereto and its successors and permitted assigns and nothing in this Agreement, express or implied, shall confer upon any other person or entity, including the public or any member thereof, any rights, benefits or remedies of any nature whatsoever.

[signatures appear on following page]

IN WITNESS WHEREOF, this Agreement has been executed by the parties to be effective on the date described in Section 1.01(k).

COUNTY:

BOARD OF COUNTY COMMISSIONERS,
COUNTY OF CLARK, STATE OF NEVADA

Attest:

By: _____
Tick Segerblom, Chair

Lynn Marie Goya, County Clerk

OWNER: Authorized Agent

JOHN PRUNA
PRINT OWNER NAME

ENTITY NAME:

RICHMOND AMERICAN HOMES OF NEVADA INC.
PRINT ENTITY NAME

By: [Signature]
Owner Signature

ACKNOWLEDGMENT:

STATE OF NEVADA)
)ss:
COUNTY OF CLARK)

This instrument was acknowledged before me on the 6 day of August, 2025,

by JOHN PRUNA
(Printed Name of Document Signer)

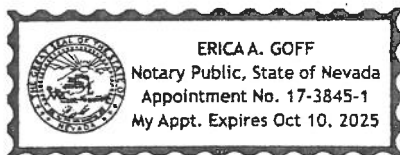

NOTARY PUBLIC

Erica A Goff
Signature

Exhibit “A”
Legal Description

(see next page for attachment)

JOB #423036-A-001

**LEGAL DESCRIPTION
RAVENNA**

BEING A PORTION OF THE NORTHWEST QUARTER (NW 1/4) OF THE NORTHEAST QUARTER (NE 1/4) OF THE NORTHWEST QUARTER (NW 1/4) OF SECTION 32, TOWNSHIP 22 SOUTH, RANGE 60 EAST, M.D.M., CLARK COUNTY, NEVADA. MORE PARTICULARLY DESCRIBED AS FOLLOWS:

COMMENCING FORM THE NORTHEAST CORNER OF SAID NORTHEAST QUARTER (NE 1/4) OF THE NORTHWEST QUARTER (NW 1/4) OF SECTION 32; THENCES ALONG THE NORTH LINE OF SAID NORTHEAST QUARTER (NE 1/4), SAME BEING THE CENTERLINE OF CACTUS AVENUE NORTH 88°39'44" WEST A DISTANCE OF 669.31 FEET; THENCE DEPARTING SAID LINES SOUTH 01°20'16" WEST A DISTANCE OF 45.00' TO THE POINT OF BEGINNING; SAME BEING A POINT ON THE EAST LINE OF THE NORTHWEST QUARTER (NW 1/4) OF THE NORTHEAST QUARTER (NE 1/4) OF THE NORTHWEST QUARTER (NW 1/4) OF SECTION 32; THENCE ALONG SAID EAST LINE SOUTH 04°28'36" EAST A DISTANCE OF 582.65 FEET TO THE SOUTH LINE OF SAID NORTHWEST QUARTER (NW 1/4); THENCE DEPARTING SAID EAST LINE ALONG SAID SOUTH LINE NORTH 89°17'31" WEST A DISTANCE OF 640.76 FEET TO THE EAST RIGHT-OF-WAY LINE OF QUARTERHORSE LANE DEDICATED IN BOOK 0236 AS INSTRUMENT NUMBER 0285362 OF OFFICAL RECORDS, CLARK COUNTY, NEVADA; THENCE ALONG SAID EAST LINE NORTH 04°40'25" WEST A DISTANCE OF 557.14 FEET TO THE BEGINNING OF A TANGENT CURVE TO THE RIGHT, CONCAVE SOUTH EASTERLY, HAVING A RADIUS OF 25 FEET THROUGH A CENTRAL ANGLE OF 96°00'41" AND AN ARC LENGTH OF 41.89 FEET TO A POINT ON THE SOUTH RIGHT OF WAY LINE OF CACTUS AVENUE AS DEDICATED IN BOOK 20220901 AS INSTRUMENT NUMBER 01563 OF OFFICAL RECORDS, CLARK COUNTY, NEVADA; THENCE DEPARTING SAID SOUTH LINE NORTH 01°20'16" EAST A DISTANCE OF 5.00 FEET; THENCE SOUTH 88°39'44" EAST A DISTANCE OF 615.18 FEET TO THE POINT OF BEGINNING.

END OF DESCRIPTION.

OVERALL ACRES: 8.60+/- ACRES.

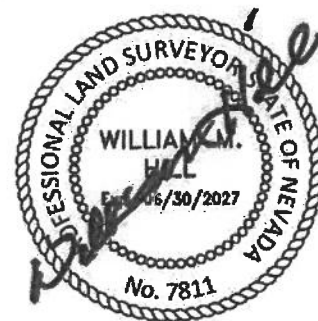

8/4/2025

Exhibit “B”
Development Agreement Owner Correspondence

Exhibit "B"
Development Agreement Owner/Applicant Correspondence

In accordance with Section 7.08, all notices, demands and correspondence required or provided for under this agreement shall be sent to the Owner and/or Applicant as follows:

Address all Correspondence as follows:

Owner

Richmond American Homes

770 W Warm Springs Road, Suite 240

Las Vegas, Nevada 89119

Applicant/Correspondent

Richmond American Homes / The WLB Group, INC

770 W Warm Springs Road, Suite 240 / 3663 E Sunset Road, Suite 204

Las Vegas, Nevada 89119 / 89120

Exhibit “C”
Agenda Sheet, Notice of Final Action, and Agenda Map
(see next page for attachments)

PUBLIC HEARING

APP. NUMBER/OWNER/DESCRIPTION OF REQUEST

WS-24-0134-DOGWOOD HICKORY, LLC:

WAIVERS OF DEVELOPMENT STANDARDS for the following: 1) reduce street landscaping; 2) increase retaining wall height; 3) increase fill height; 4) waive full off-sites; and 5) allow a non-standard improvement within the right-of-way.

DESIGN REVIEWS for the following: 1) alternative landscape plan; and 2) single family residential development on 8.59 acres in an RS-10 (Residential Single-Family 10) Zone.

Generally located on the southeast corner of Cactus Avenue and Quarterhorse Lane within Enterprise. JJ/jor/ng (For possible action)

RELATED INFORMATION:

APN:

176-32-101-008; 176-32-101-009

WAIVERS OF DEVELOPMENT STANDARDS:

1. Reduce street landscaping area along Quarterhorse Lane to 5 feet where 10 feet is required per Section 30.04.08 and Section 30.04.01D.
2. Increase the height of a retaining wall to 8 feet where 3 feet is the maximum per Section 30.04.03C (a 167% increase).
3. Increase fill height to 8 feet where a maximum of 6 feet is allowed to be placed between 5 feet to 20 feet from a shared residential property line per Section 30.04.06F (a 33% increase).
4. Waive full off-site improvements (curb, gutter, sidewalk, streetlights, and partial paving) along Quarterhorse Lane where off-site improvements are required per Section 30.04.08.
5. Allow a non-standard improvement within the right-of-way (5 feet of a 10 foot wide equestrian trail along Quarterhorse Lane) per Section 30.04.08.

PROPOSED LAND USE PLAN:

LOW-INTENSITY SUBURBAN NEIGHBORHOOD (UP TO 5 DU/AC)

BACKGROUND:

Project Description

General Summary

- Site Address: None
- Site Acreage: 8.59
- Project Type: Single family residential
- Number of Lots: 24
- Density (du/ac): 2.79

- Minimum/Maximum Lot Size (square feet): 14,503 (gross)/16,903 (gross) and 12,156 (net)/16,101 (net)
- Number of Stories: 1
- Building Height (feet): 22 (maximum)
- Square Feet: 3,375 to 4,019

History, Site Plan, & Request

The site was previously approved for a 27 lot single family residential development via NZC-22-0121 on June 2022. Today, a new design is proposed, resulting in a new land use entitlement request per the applicant.

The plan depicts the subject parcels as a proposed single family residential subdivision on 8.59 acres with a density of 2.79 dwelling units per acre. The applicant is proposing 24 lots with a minimum net lot size of 12,156 square feet and maximum net lot size of 16,101 square feet. Lots 1 through 12 are located on the west side of the development adjacent to Quarterhorse Lane and these lots face internally on 1 private street which terminates in a hammerhead design. Lots 13 through 24 are on the east side of the development and mirrors the same layout of lots to the west, terminating in a second cul-de-sac. The main access for both private streets is from Cactus Avenue to the north.

Lastly, the applicant is requesting the following: eliminate the requirement for detached sidewalks and allow reduced street landscaping (a 5 foot wide landscape strip) along Quarterhorse Lane, waive full off-site improvements along Quarterhorse Lane, allow a non-standard improvement within the right-of-way (a 10 foot wide equestrian trail) along Quarterhorse Lane, increase the retaining wall height, and increase the amount of fill up to 8 feet. The applicant submitted plans which depicts increased fill along the east and south property lines. The applicant is requesting to increase the fill height to a maximum of 8 feet between Lot 20 and Lot 21. Lastly, a design review is required for the proposed homes.

Landscaping

The applicant submitted an alternative landscape plan which depicts a 5 foot wide landscape strip along the west property line of the development adjacent to Quarterhorse Lane. This 5 foot wide landscape strip includes a mix of 9 large trees spaced every 30 feet, and 15 medium trees spaced every 20 feet on center; where Title 30 requires 19 large trees spaced every 30 feet on center. However, with the addition of medium trees, the required number of street trees is met. The applicant is also requesting to install a 10 foot wide equestrian trail where 5 feet will be within the right-of-way and the remaining 5 feet will be within the applicant's site.

Furthermore, the applicant is proposing detached sidewalks with street landscaping along the north property line adjacent to Cactus Avenue. The street landscaping in this area also includes an alternative landscape design of large and medium trees with shrubs in between. Title 30 requires 18 large trees spaced every 30 feet on center (with the exception of the driveways) to be planted along Cactus Avenue. With the proposed alternative landscape design along Cactus Avenue, approximately 7 large trees and 14 medium trees will be planted. All proposed plants comply with the Southern Nevada Water Authority (SNWA) Plant List.

Elevations & Floor Plan

The applicant is proposing 3 model homes which range from an overall floor plan area of 3,375 square feet to 4,019 square feet. The homes include typical residential rooms and areas such as bedroom, bathrooms, a kitchen, living room, and entry area. The elevation plans depict 1 story residences with a maximum height of 22 feet. The elevations include covered entry ways, variable rooflines, stone veneer, a neutral paint color palette, window trim, a courtyard area within the front facing elevation, and a 3 car garage.

Applicant's Justification

The applicant is proposing to develop a detached single family residential community consisting of 24 lots at a density of 2.79 units per acre. All the homes are single story in height and will range in size from 3,375 square feet to 4,019 square feet. The homes will feature tile roofs, some of the elevations will have stone accents and all exterior elevations will have window treatments with a neutral color palette to blend with the natural surroundings.

The applicant is requesting to waive the requirement for detached sidewalks with alternative landscaping and eliminate off-site improvements along Quarterhorse Lane, due to the neighbor's request to keep the street rural in character. The retaining wall height waiver from 6 feet to 8 feet in certain areas across the overall site with most of the request being along the south and east boundary lines. This is being requested to fill in low spots within the natural topology of the land and/or to address grading requirements internal to the site and not being requested to artificially raise the land for views. An additional waiver is requested to increase the amount of fill between 5 feet and 20 feet from a shared property line. The fill ranges from 6 feet to 8 feet for 2 small areas of the site, due to the existing topology being lower in these 2 areas than the surrounding elevations. Lastly, the request to allow a non-standard improvement within the right-of-way to install a 10 foot wide equestrian trail that is split by the property line. The proposed equestrian trail will be installed with 5 feet in the public right-of-way and 5 feet in proposed development. The equestrian trail will consist of compacted 3/8" minus decomposed granite and will be maintained by the homeowner's association. The applicant acknowledges that this will require a license and maintenance agreement with Clark County.

Prior Land Use Requests

Application Number	Request	Action	Date
NZC-22-0121	Reclassified the site from R-E to R-D zoning for a 27 lot single family residential development	Approved by BCC	June 2022
NZC-19-0250	Reclassified the site from R-E to R-2 zoning for a single family residential subdivision	Withdrawn	August 2019
TM-19-500077	64 lot single family residential subdivision	Withdrawn	August 2019
VS-19-0251	Vacated and abandoned patent easements	Withdrawn	August 2019

Surrounding Land Use

	Planned Land Use Category	Zoning District (Overlay)	Existing Land Use
North	Mid-Intensity Suburban Neighborhood (up to 8 du/ac)	RS3.3	Single family residential
South, East, & West	Open Lands	RS20	Undeveloped

The subject site is within the Public Facilities Needs Assessment (PFNA) area.

Related Applications

Application Number	Request
ZC-24-0136	A zone change to reclassify the site from RS20 to RS10 zoning is a companion item on this agenda.
PA-24-700004	A plan amendment to redesignate the existing land use category from Open Lands (OL) to Low-Intensity Suburban Neighborhood (LN) is a companion item on this agenda.
VS-24-0135	A vacation and abandonment for patent easements and a 5 foot wide portion of right-of-way being Cactus Avenue is a companion item on this agenda.
TM-24-500034	A tentative map for a 24 lot single family residential development is a companion item on this agenda.

STANDARDS FOR APPROVAL:

The applicant shall demonstrate that the proposed request is consistent with the Master Plan and is in compliance with Title 30.

Analysis**Comprehensive Planning**Waivers of Development Standards

The applicant shall have the burden of proof to establish that the proposed request is appropriate for its proposed location by showing the following: 1) the use(s) of the area adjacent to the subject property will not be affected in a substantially adverse manner; 2) the proposal will not materially affect the health and safety of persons residing in, working in, or visiting the immediate vicinity, and will not be materially detrimental to the public welfare; and 3) the proposal will be adequately served by, and will not create an undue burden on, any public improvements, facilities, or services.

Waiver of Development Standards #1

The applicant is requesting to allow reduced street landscaping along Quarterhorse Lane to 5 feet where 10 feet is required per Section 30.04.08 and Section 30.04.01D. The applicant is proposing a 5 foot wide landscape strip with large and medium trees adjacent to a 10 foot wide equestrian trail that is 5 feet within the right-of-way. The applicant has the opportunity to mirror the proposed street landscaping along Cactus Avenue adjacent to the north property line of the proposed subdivision. Appropriate street landscaping encourages the enhancement of community character and the appearance of development and streetscapes using low-water, climate-appropriate plant materials; furthermore, the required landscaping helps reduce the impacts of

wind, dust, pollution, glare, and heat island effect on human health and comfort. For these reasons, staff does not support the proposed street landscaping design along Quarterhorse Lane.

Waivers of Development Standards #2 & #3

Per the applicant, the increased retaining wall height request is due to the existing topography of the site. The applicant submitted plans demonstrating a maximum wall combination of a 6 foot screen/8 foot retaining wall height along the west property line adjacent to Lot 2 and Lot 3. The 8 foot retaining wall in this location is internal to the subdivision and cannot be seen from the right-of-way because Quarterhorse Lane is at a higher grade.

In addition, there is a proposed 5 foot wide drainage channel along the east and south property lines. The applicant is proposing a maximum wall combination of a 6 foot screen/7 foot retaining wall height along the east property line. Visually, future development to the east will view a 6 foot high screen wall to accommodate a drainage channel, and behind it will be a combination of a 6 foot screen/7 foot retaining wall due to the proposed lots.

Lastly, the applicant submitted plans which depict increased fill height along the east and south property lines. The applicant is requesting to increase the fill height to a maximum of 8 feet between Lot 20 and Lot 21. Per Section 30.04.06.F, grading shall not place more than 6 feet of fill when located between 5 feet and 20 feet from a shared property line. Although the 1 foot increase may not impact the neighbors, since staff does not support the companion tentative map, waivers of development standards, and the design reviews, staff also cannot support this request.

Design Reviews

Development of the subject property is reviewed to determine if 1) it is compatible with adjacent development and is harmonious and compatible with development in the area; 2) the elevations, design characteristics and others architectural and aesthetic features are not unsightly or undesirable in appearance; and 3) site access and circulation do not negatively impact adjacent roadways or neighborhood traffic.

Staff finds that the overall site design depicts a lack of connectivity within the overall subdivision. Furthermore, the proposed home design does not have the 4 sided architecture required per Section 30.04.05. Elevation plans show that the side elevations do not feature at least 2 architectural features that should be provided on each façade of the structure per Section 30.04.05.E.2. Lastly, since staff does not support the aforementioned waivers of development standards staff does not support these design reviews.

Public Works - Development Review

Waiver of Development Standards #4

Historical events have demonstrated how important off-site improvements are for drainage control. Additionally, full width paving allows for better traffic flow and sidewalks on public streets provide safer pathways for pedestrians and for children to walk to school. Therefore, staff cannot support the waiver of development standards for full off-site improvements. The Cactus Avenue capital improvement project has completed a majority of the off-sites along Cactus Avenue and Quarterhorse Lane should be improved also.

Waiver of Development Standards #5

Staff cannot support the request for an equestrian trail as a non-standard improvement in the right-of-way.

Staff Recommendation

Denial. This item has been forwarded to the Board of County Commissioners' meeting for final action.

If this request is approved, the Board and/or Commission finds that the application is consistent with the standards and purpose enumerated in the Master Plan, Title 30, and/or the Nevada Revised Statutes.

PLANNING COMMISSION ACTION: May 21, 2024 – APPROVED – Vote: Unanimous
Absent: Frasier

Comprehensive Planning

- Expunge NZC-22-0121;
- Single story homes only;
- Enter into a standard development agreement prior to any permits or subdivision mapping in order to provide fair-share contribution toward public infrastructure necessary to provide service because of the lack of necessary public services in the area;
- Certificate of Occupancy shall not be issued without approval of a Certificate of Compliance.
- Applicant is advised within 4 years from the approval date the application must commence or the application will expire unless extended with approval of an extension of time; a substantial change in circumstances or regulations may warrant denial or added conditions to an extension of time; the extension of time may be denied if the project has not commenced or there has been no substantial work towards completion within the time specified; changes to the approved project will require a new land use application; and the applicant is solely responsible for ensuring compliance with all conditions and deadlines.

Public Works - Development Review

- Coordinate with Public Works on a landscape barrier on the west side of the equestrian trail along Quarterhorse Lane;
- Install "No Parking" signs on Quarterhorse Lane;
- Drainage study and compliance;
- Traffic study and compliance;
- Right-of-way dedication to include the spandrel in the northwest corner of the site at the intersection of Cactus Avenue and Quarterhorse Lane;
- 30 days to submit a Separate Document to the Map Team for the required right-of-way dedications and any corresponding easements for any collector street or larger;
- 90 days to record required right-of-way dedications and any corresponding easements for any collector street or larger;
- Execute a Restrictive Covenant Agreement (deed restrictions);
- Execute a License and Maintenance Agreement for any non-standard improvements within the right-of-way;

- Coordinate with Public Works - Construction Division for right-of-way and easement dedications necessary for the Cactus Avenue project.
- Applicant is advised that the installation of detached sidewalks will require vacation to back of curb and granting necessary easements for utilities, pedestrian access, streetlights, and traffic control.

Fire Prevention Bureau

- Applicant is advised that fire/emergency access must comply with the Fire Code as amended.

Clark County Water Reclamation District (CCWRD)

- Applicant is advised that a Point of Connection (POC) request has been completed for this project; to email sewerlocation@cleanwaterteam.com and reference POC Tracking #0448-2023 to obtain your POC exhibit; and that flow contributions exceeding CCWRD estimates may require another POC analysis.

TAB/CAC: Enterprise - approval (emergency egress at each end of the hammerheads).

APPROVALS:

PROTESTS: 7 cards, 2 letters

APPLICANT: DOGWOOD HICKORY, LLC

CONTACT: THE WLB GROUP, INC., 3663 E. SUNSET ROAD, SUITE 204, LAS VEGAS, NV 89120



Department of Comprehensive Planning

500 S Grand Central Pkwy • Box 551741 • Las Vegas NV 89155-1741
(702) 455-4314 • Fax (702) 455-3271

Sami Real, Director

NOTICE OF FINAL ACTION

July 01, 2024

THE WLB GROUP, INC.
3663 E. SUNSET RD, STE 204
LAS VEGAS, NV 89120

REFERENCE: WS-24-0134

On the date indicated above, a Notice of Final Action was filed with the Clark County Clerk, Commission Division, pursuant to NRS 278.0235 and NRS 278.3195, which starts the commencement of the twenty-five (25) day limitation period specified therein.

The above referenced application was presented before the Clark County Board of County Commissioners at their regular meeting of **June 18, 2024**. The final decision along with any conditions are listed below. You will be required to comply with all conditions prior to the issuance of a building permit or a business license, whichever occurs first.

Time limits to commence, complete or review this approval, apply only to this specific application. A property may have several approved applications on it with each having its own expiration date. **It is the applicant's responsibility to keep the application current.**

APPROVED.

CONDITIONS OF APPROVAL - Comprehensive Planning

- Expunge NZC-22-0121;
- Single story homes only;
- Enter into a standard development agreement prior to any permits or subdivision mapping in order to provide fair-share contribution toward public infrastructure necessary to provide service because of the lack of necessary public services in the area;
- Certificate of Occupancy shall not be issued without approval of a Certificate of Compliance.
- Applicant is advised within 4 years from the approval date the application must commence or the application will expire unless extended with approval of an extension of time; a substantial change in circumstances or regulations may warrant denial or added conditions to an extension of time; the extension of time may be denied if the project has not commenced or there has been no substantial work towards completion within the time specified; changes to the approved project will require a new land use application; and the applicant is solely responsible for ensuring compliance with all conditions and deadlines.

Public Works - Development Review

- Coordinate with Public Works on a landscape barrier on the west side of the equestrian trail along Quarterhorse Lane;
- Install "No Parking" signs on Quarterhorse Lane;
- Drainage study and compliance;

BOARD OF COUNTY COMMISSIONERS

TICK SEGERBLOM, Chair • WILLIAM MCCURDY II, Vice Chair
MICHAEL NAFT • MARILYN KIRKPATRICK • JUSTIN C. JONES • ROSS MILLER • JAMES B. GIBSON
KEVIN SCHILLER, County Manager



Department of Comprehensive Planning

500 S Grand Central Pkwy • Box 551741 • Las Vegas NV 89155-1741
(702) 455-4314 • Fax (702) 455-3271

Sami Real, Director

- **Traffic study and compliance;**
- **Right-of-way dedication to include the spandrel in the northwest corner of the site at the intersection of Cactus Avenue and Quarterhorse Lane;**
- **30 days to submit a Separate Document to the Map Team for the required right-of-way dedications and any corresponding easements for any collector street or larger;**
- **90 days to record required right-of-way dedications and any corresponding easements for any collector street or larger;**
- **Execute a Restrictive Covenant Agreement (deed restrictions);**
- **Execute a License and Maintenance Agreement for any non-standard improvements within the right-of-way;**
- **Coordinate with Public Works - Construction Division for right-of-way and easement dedications necessary for the Cactus Avenue project.**
- **Applicant is advised that the installation of detached sidewalks will require vacation to back of curb and granting necessary easements for utilities, pedestrian access, streetlights, and traffic control.**

Fire Prevention Bureau

- **Applicant is advised that fire/emergency access must comply with the Fire Code as amended.**

Clark County Water Reclamation District (CCWRD)

- **Applicant is advised that a Point of Connection (POC) request has been completed for this project; to email sewerlocation@cleanwaterteam.com and reference POC Tracking #0448-2023 to obtain your POC exhibit; and that flow contributions exceeding CCWRD estimates may require another POC analysis.**

BOARD OF COUNTY COMMISSIONERS

TICK SEGERBLOM, Chair • WILLIAM MCCURDY II, Vice Chair
MICHAEL NAFT • MARILYN KIRKPATRICK • JUSTIN C. JONES • ROSS MILLER • JAMES B. GIBSON
KEVIN SCHILLER, County Manager

