

~~[Bracketed and strikethrough]~~ material is that portion being deleted
Underlined and italicized material is that portion being added

BILL NO. 1-6-26-1

SUMMARY – An Ordinance to amend the boundaries of the area served by the Lower Kyle Canyon Citizens Advisory Council; and to change its name.

ORDINANCE NO. _____

(of Clark County, Nevada)

AN ORDINANCE TO AMEND THE BOUNDARIES OF
THE AREA SERVED BY THE LOWER KYLE
CANYON CITIZENS ADVISORY COUNCIL;
CHANGING THE NAME OF THE ADVISORY
COUNCIL AND PROVIDING FOR OTHER MATTERS
PROPERLY RELATING THERETO.

WHEREAS, Clark County Code 3.32 provides for the establishment of Citizens Advisory Councils; and;

WHEREAS, the Lower Kyle Canyon Citizens Advisory Council was created by Clark County Ordinance No. 2449, passed March 21, 2000; and;

WHEREAS, the Lower Kyle Canyon Citizens Advisory Council boundaries were amended by Clark County Ordinance No. 2726, passed on March 5, 2002;

WHEREAS, part of the boundaries of the Lower Kyle Canyon Citizens Advisory Council was annexed to the City of Las Vegas on July 22, 2025, and the Council has need to amend its boundaries; and;

WHEREAS, because of the change of boundaries the Council is in need for a new name which more clearly and accurately describes the boundaries and jurisdiction of the Council;

NOW, THEREFORE, THE BOARD OF COUNTY COMMISSIONERS DOES HEREBY
ORDAIN AS FOLLOWS:

SECTION ONE. That the territory included in the Council's jurisdictional boundary, as outlined in Section 1 of Ordinance 2726, be amended to conform to the Map and Legal Description attached as Exhibit 1, as may be amended from time to time to exclude any territory annexed by the City of Las Vegas.

SECTION TWO. That the name given to the Lower Kyle Canyon Citizens Advisory Council, in Ordinance 2449, be amended to Upper and Lower Kyle Canyon Citizens Advisory Council.

SECTION THREE. If any section of this ordinance or portion thereof is for any reason held invalid or unconstitutional by any court of competent jurisdiction, such holding shall not invalidate the remaining parts of this ordinance.

SECTION FOUR. All ordinances, parts of ordinances, chapters, sections, subsections, clauses, phrases or sentences contained in the Clark County Code in conflict herewith are hereby repealed.

SECTION FIVE. This ordinance shall take effect and be in force from and after its passage and the publication thereof by title only, together with the names of the County Commissioners voting for or against its passage, in a newspaper published in and having a general circulation in Clark County, Nevada, at least once a week for a period of two (2) weeks.

PROPOSED on the ____ day of _____, 2026.

PROPOSED BY: Commissioner _____

PASSED on the ____ day of _____ 2026.

AYES: _____

NAYS: _____

ABSTAINING: _____

ABSENT: _____

BOARD OF COUNTY COMMISSIONERS
CLARK COUNTY, NEVADA

BY: _____
MICHAEL NAFT, CHAIR

ATTEST:

LYNN MARIE GOYA, County Clerk

This ordinance shall be in force and effect from and after
the _____ day of _____ 2026.

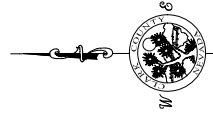

NO SCALE

LEGAL DESCRIPTION
LOWER KYLE CANYON
CITIZENS ADVISORY COUNCIL
JURISDICTIONAL BOUNDARY

All of that certain territory described as Lower Kyle Canyon Citizens Advisory Council, created by Clark County Ordinance No. 2449, Passed on March 21, 2000;
TOGETHER WITH that certain Amended Jurisdictional Boundary of the Lower Kyle Canyon Citizens Advisory Board, created by Clark County Ordinance No. 2726, Passed on March 5, 2002;
EXCEPTING THEREFROM all that area annexed to the City of Las Vegas, Nevada.

CITY OF LAS VEGAS
ANNEXATION
AS OF 7-22-2025

T. 19 S.
T. 19 S.
R. 57 E.
R. 56 E.

R. 59 E.
R. 58 E.
R. 57 E.
R. 56 E.

SEE ANNEXATION
DETAIL
SHEET 2 OF 2

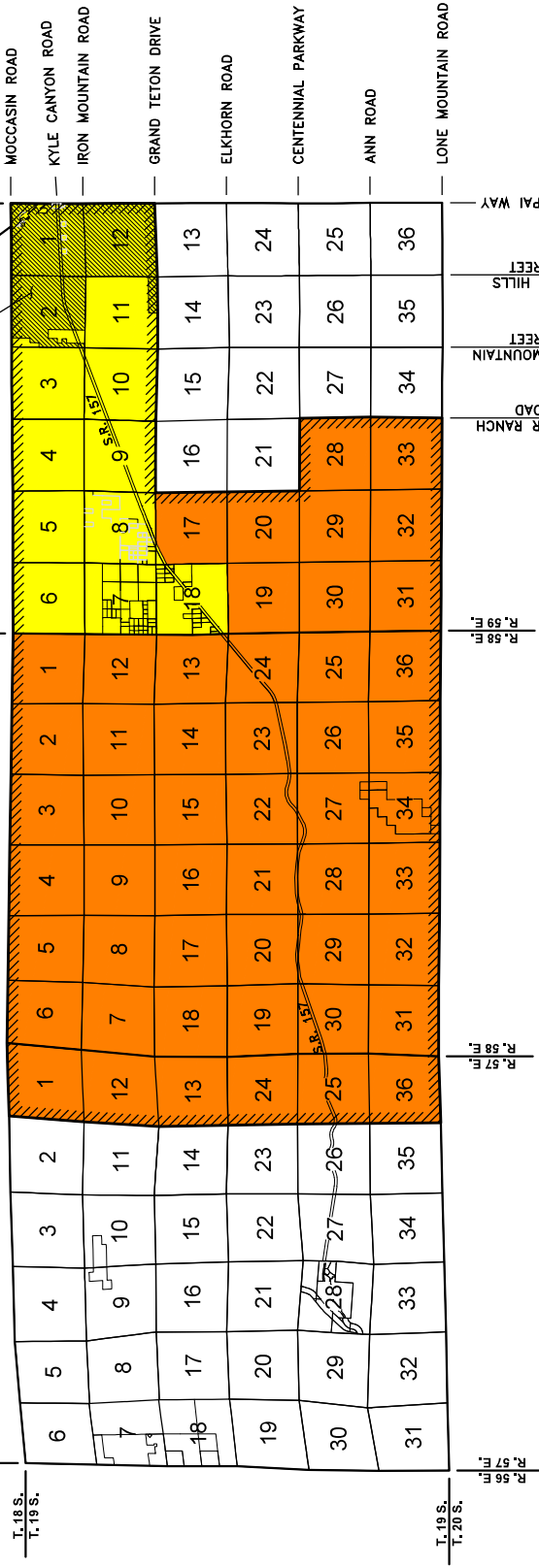

LEGEND

- JURISDICTIONAL BOUNDARY FOR LOWER KYLE CANYON, CITIZENS ADVISORY COUNCIL, PER CLARK COUNTY ORDINANCE NO. 2449 AND 2726.
- TOWNSHIP OR RANGE LINE
- SECTION LINE
- 16 SECTION NUMBER

LOWER KYLE CANYON
CITIZENS ADVISORY COUNCIL
JURISDICTIONAL BOUNDARY

SURVEYORS CERTIFICATE

This is to certify that this map, prepared under my direct supervision, correctly delineates the limits of the Lower Kyle Canyon Citizens Advisory Council Jurisdictional Boundary.

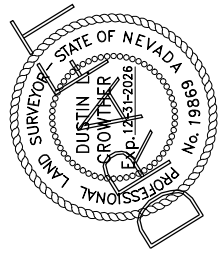

Dustin L. Crowther, P.L.S.
Nevada Certificate No. 19869
Clark County Surveyor

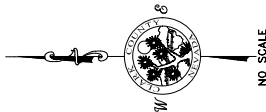

ANNEXATION DETAIL
Sections 1, 2, 11 and 12, Township 19 South,
Range 59 East, M.D.M., Clark County, Nevada.

T. 18 S.
T. 19 S.

| ANNEXATIONS | | |
|-------------|-----------|------------------|
| # | ORDINANCE | INSTRUMENT |
| 1 | 5230 | 20000628-0000403 |
| 2 | 5276 | 20010111-0000549 |
| 3 | 5322 | 20010510-0001155 |
| 4 | 5397 | 20020109-0002026 |
| 5 | 5425 | 20020214-0001415 |
| 6 | 5426 | 20020214-0001416 |
| 7 | 5774 | 20050610-0003473 |
| 8 | 5929 | 20070913-0001218 |
| 9 | 5930 | 20070913-0001219 |
| 10 | 5988 | 20080611-0004818 |
| 11 | 5990 | 20080625-0003529 |
| 12 | 6034 | 20090520-0003237 |
| 13 | 6502 | 20160209-0000454 |
| 14 | 6563 | 20170110-0000975 |
| 15 | 6909 | 20250722-0001999 |
| 16 | 6884 | 20250722-0002000 |

