

EXHIBIT "A-3"

Legal Description for Harmon Avenue Bridge
at Dean Martin Drive

APN's 162-20-213-000, 162-20-299-016, 162-20-299-020, 162-20-299-024,
162-20-299-033, 162-20-299-041, 162-20-311-000, 162-20-399-008,
162-20-399-012, 162-20-399-013, 162-20-399-014, 162-20-399-048,
162-20-399-053, 162-20-699-006, 162-20-699-017, 162-20-799-002

Page 1 of 2

Explanation: The purpose of this description is for the transfer of a portion of Interstate 15/Harmon Avenue grade separation structure and associated components contained within the hereinafter described area, being the west edge of the west approach slab to the west line of the Interstate 15 right-of-way, and from fifteen (15) feet outside the outside face of the south bridge/barrier rail to fifteen (15) feet outside the outside face of the north bridge/barrier rail.

DESCRIPTION

A portion of Section 20, Township 21 South, Range 61 East, M.D.M., Clark County, Nevada, being more particularly described as follows:

COMMENCING at the southeast corner of the Southeast Quarter (SE ¼) of the Northwest Quarter (NW ¼) of said Section 20;

Thence North 89° 05' 14" West, along the south line of said Southeast Quarter (SE ¼), 129.50 feet, to the **POINT OF BEGINNING**;

Thence departing said south line, North 0° 08' 32" East, 60.01 feet;

Thence South 89° 05' 14" East, 150.32 feet, to the east line of that parcel of land as described and shown in that certain Resolution of Acceptance recorded in Book 754, Instrument 713640, on file in the Official Records of the Clark County Recorder, Clark County, Nevada;

Thence South 0° 08' 22" West, along said east line, 115.51 feet;

Thence departing said east line, North 89° 05' 14" West, 150.32 feet;

Thence North 0° 08' 32" East, 55.50 feet to the **POINT OF BEGINNING**.

BASIS OF BEARINGS

North 89° 05' 14" West, being the south line of the Northwest Quarter (NW ¼) of Section 20, Township 21 South, Range 61 East, M.D.M, Clark County, Nevada, as shown on that certain Record of Survey, File 153, Page 48, on file in the Official Records of the Clark County Recorder, Clark County, Nevada.

This description was prepared by the Clark County Surveyor's Office from documents of record and the results of a topographic field survey. See **Exhibit "B-3"** attached hereto, and by this reference made a part hereof.

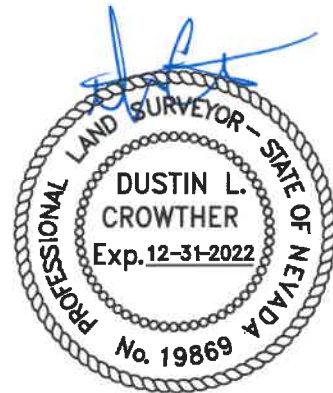

3-1-2021

Dustin L. Crowther, P.L.S.
Nevada Certificate No. 19869
Clark County Surveyor

EXHIBIT "B-3"

CLARK COUNTY PUBLIC WORKS
SURVEY DIVISION

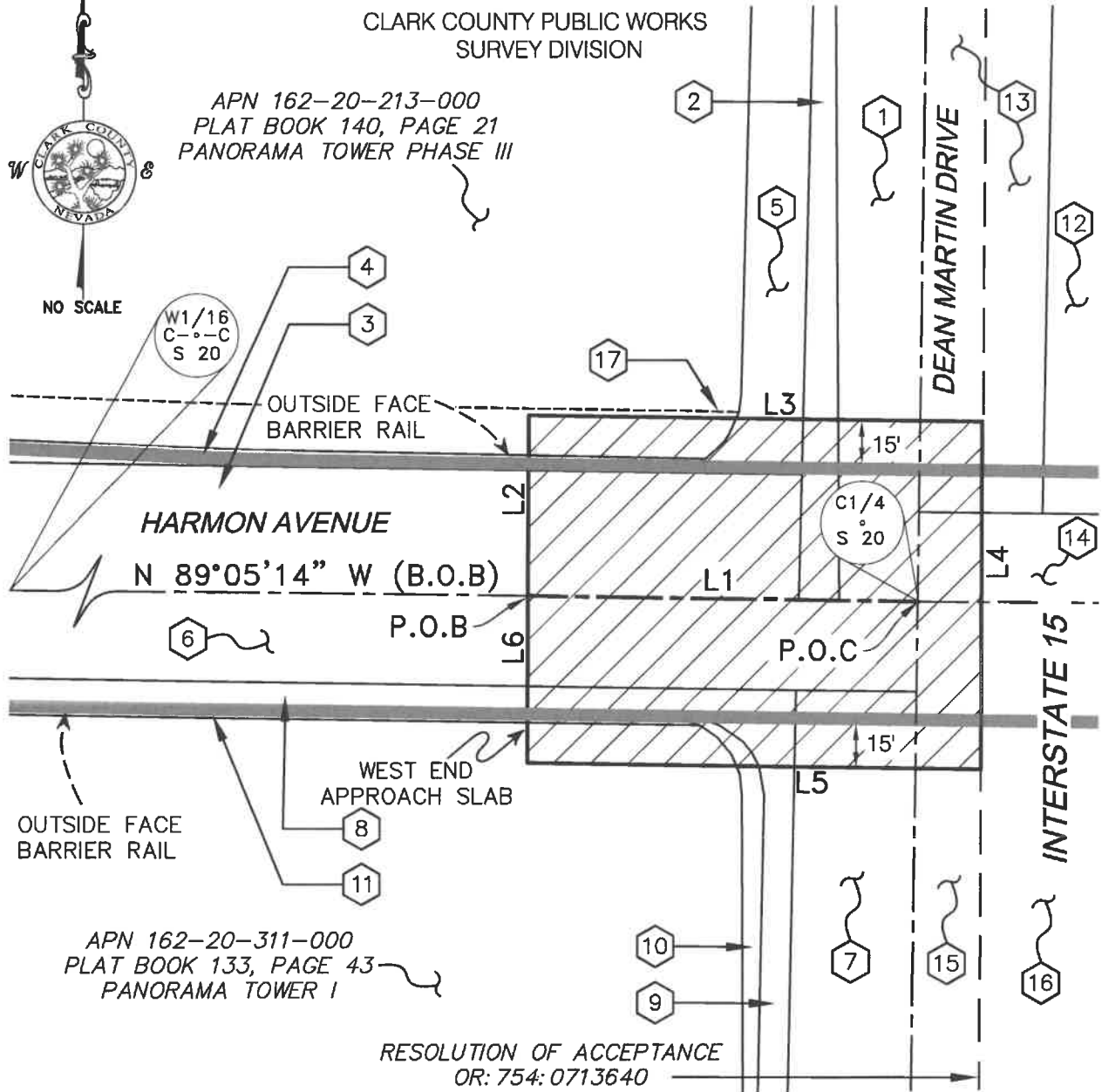

NOTE: AREA SHOWN IS DERIVED FROM DOCUMENTS OF RECORD AND THE RESULTS OF A FIELD SURVEY.



DESCRIBED AREA

PARCEL NUMBER:

162-20-213-000; 162-20-299-016; 162-20-299-020; 162-20-299-024;

162-20-299-033; 162-20-299-041; 162-20-311-000; 162-20-399-008;

162-20-399-012; 162-20-399-013; 162-20-399-014; 162-20-399-048;

162-20-399-053; 162-20-699-006; 162-20-699-017; 162-20-799-002

SECTION, TOWNSHIP, RANGE:
REFERENCES:

SECTION 20, TOWNSHIP 21 SOUTH, RANGE 61 EAST, M.D.M.

RECORD OF SURVEY FILE 153, PAGE 48; QUITCLAIM: 386:311289

RELINQUISHMENT: 754:713639; RESOLUTION OF ACCEPTANCE: 754:713640

IMPROVEMENT PLANS FOR HARMON AVENUE FROM POLARIS AVENUE TO LAS VEGAS BLVD (L-1542)

EXHIBIT "B-3"

CLARK COUNTY PUBLIC WORKS
SURVEY DIVISION

Line Table		
Line #	Direction	Length
L1	N89°05'14"W	129.50'
L2	N0°08'32"E	60.01'
L3	S89°05'14"E	150.32'
L4	S0°08'22"W	115.51'
L5	N89°05'14"W	150.32'
L6	N0°08'32"E	55.50'

1

APN 162-20-299-016
OR: 63: 053476

10

APN 162-20-399-048
OR: 19960131: 01992

2

APN 162-20-299-020
OR: 63: 053476

11

APN 162-20-399-053
OR: 20000619: 01301

3

APN 162-20-299-024
OR: 63: 053476

12

APN 162-20-699-003
OR: 719:578204

4

APN 162-20-299-033
OR: 19990603: 298

13

APN 162-20-699-006
OR:103:085264

5

APN 162-20-299-041
OR: 1917:1876748

14

APN 162-20-699-017
OR: 71:409987

6

APN 162-20-399-008
OR: 71: 0409985

15

APN 162-20-799-002
OR: 754: 0713639

7

APN 162-20-399-012
OR: 103: 085147

16

APN 162-20-799-003
OR: 719: 578203

8

APN 162-20-399-013
OR: 452: 364164

17

EASEMENT
OR: 19990603: 00297

9

APN 162-20-399-014
OR: 1960: 1919749