

Amendment II to Lease Agreement Between Clark County and Family to Family Connection

**AMENDMENT II TO LEASE AGREEMENT
BETWEEN
CLARK COUNTY
AND
FAMILY TO FAMILY CONNECTION**

THIS AMENDMENT II TO LEASE AGREEMENT (“Amendment II”) is made and entered into this ____ day of _____, 2026 by and between CLARK COUNTY, a political subdivision of the State of Nevada (“LESSOR” or “COUNTY”) and Family to Family Connection, a non-profit corporation qualified to do business in Nevada (“LESSEE”)(Individually a “Party” and collectively the “Parties”).

WHEREAS, the Parties entered into a Lease Agreement dated February 1, 2022 (the “Lease Agreement”) to occupy +/- 2,785 square feet of office space located at 3900 Cambridge Street, Suites 106, 107 & 108, Las Vegas, NV 89119, expiring on November 4, 2026;

WHEREAS, the Parties entered into an Amendment I to Lease Agreement dated June 4, 2024, to clarify service responsibility (“Amendment I”);

WHEREAS, the Lease Agreement and Amendment I shall be collectively known as the “Lease”; and

WHEREAS, LESSEE desires to renew the Lease;

NOW, THEREFORE, in consideration of the promises and mutual covenants and agreements hereinafter contained, the Parties hereto agree as follows:

1. The Parties agree that the Lease shall hereby extend for three (3) years commencing on November 5, 2026, and expiring on November 4, 2029, with the option to extend for two (2) additional one (1) year periods to be exercised by giving formal written notice to COUNTY at least sixty (60) days before expiration of the prior term and receiving approval and written concurrence from the COUNTY to exercise any and each option period.
2. Except as expressly amended in this Amendment II, the Lease shall remain in full force and effect.
3. This Amendment II may be signed in any number of counterparts, each of which shall be deemed to be original and all of which together shall be deemed to be one and the same Amendment II. Delivery of this Amendment II may be accomplished by electronic transmission of this Amendment II. In such an event, the Parties hereto shall promptly thereafter deliver to each other executed counterpart originals of this Amendment II.

Amendment II to Lease Agreement Between Clark County and Family to Family Connection

IN WITNESS WHEREOF, we have hereto set our hands this _____ day of _____, 2026

COUNTY:

LESSEE:

CLARK COUNTY

FAMILY TO FAMILY CONNECTION

By _____
Shauna Bradley, Director
Real Property Management

By _____
Karen Wilkes
President

APPROVED AS TO FORM

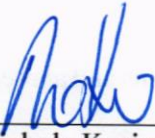
By  _____
Nichole Kazimirovicz
Deputy District Attorney

DISCLOSURE OF OWNERSHIP/PRINCIPALS

Business Entity Type (Please select one)						
<input type="checkbox"/> Sole Proprietorship	<input type="checkbox"/> Partnership	<input type="checkbox"/> Limited Liability Company	<input type="checkbox"/> Corporation	<input type="checkbox"/> Trust	<input checked="" type="checkbox"/> Non-Profit Organization	<input type="checkbox"/> Other
Business Designation Group (Please select all that apply)						
<input type="checkbox"/> MBE	<input type="checkbox"/> WBE	<input type="checkbox"/> SBE	<input type="checkbox"/> PBE	<input type="checkbox"/> VET	<input type="checkbox"/> DVET	<input type="checkbox"/> ESB
Minority Business Enterprise	Women-Owned Business Enterprise	Small Business Enterprise	Physically Challenged Business Enterprise	Veteran Owned Business	Disabled Veteran Owned Business	Emerging Small Business
Number of Clark County Nevada Residents Employed:						
Corporate/Business Entity Name: Family to Family Connection						
(Include d.b.a., if applicable)						
Street Address:		3900 Cambridge St, Suite 107		Website: www.family2familylv.org		
City, State and Zip Code:		Las Vegas, NV 89119		POC Name: Jennifer Fox Email: jennifer@family2familylv.org		
Telephone No:		702-870-9583		Fax No:		
Nevada Local Street Address: (If different from above)				Website:		
City, State and Zip Code:				Local Fax No:		
Local Telephone No:				Local POC Name: Email:		

All entities, with the exception of publicly-traded and non-profit organizations, must list the names of individuals holding more than five percent (5%) ownership or financial interest in the business entity appearing before the Board.

Publicly-traded entities and non-profit organizations shall list all Corporate Officers and Directors in lieu of disclosing the names of individuals with ownership or financial interest. The disclosure requirement, as applied to land-use applications, extends to the applicant and the landowner(s).

Entities include all business associations organized under or governed by Title 7 of the Nevada Revised Statutes, including but not limited to private corporations, close corporations, foreign corporations, limited liability companies, partnerships, limited partnerships, and professional corporations.

Full Name	Title	% Owned (Not required for Publicly Traded Corporations/Non-profit organizations)
Shannon Bilbray-Axelrod	Board President	_____
Karen Wilkes	Board Vice-President	_____
Marsha Hayes	Board Secretary	_____
Jennifer Fox, Executive Director		_____

This section is not required for publicly-traded corporations. Are you a publicly-traded corporation? Yes No

1. Are any individual members, partners, owners or principals, involved in the business entity, a Clark County, Department of Aviation, Clark County Detention Center or Clark County Water Reclamation District full-time employee(s), or appointed/elected official(s)?
 Yes No (If yes, please note that County employee(s), or appointed/elected official(s) may not perform any work on professional service contracts, or other contracts, which are not subject to competitive bid.)

2. Do any individual members, partners, owners or principals have a spouse, registered domestic partner, child, parent, in-law or brother/sister, half-brother/half-sister, grandchild, grandparent, related to a Clark County, Department of Aviation, Clark County Detention Center or Clark County Water Reclamation District full-time employee(s), or appointed/elected official(s)?
 Yes No (If yes, please complete the Disclosure of Relationship form on Page 2. If no, please print N/A on Page 2.)

I certify under penalty of perjury, that all of the information provided herein is current, complete, and accurate. I also understand that the Board will not take action on land-use approvals, contract approvals, land sales, leases or exchanges without the completed disclosure form.

Signature	Jennifer Fox Print Name
Executive Director	3/25/2024 Date
Title	

DISCLOSURE OF RELATIONSHIP

List any disclosures below:
(Mark N/A, if not applicable.)

NAME OF BUSINESS OWNER/PRINCIPAL	NAME OF COUNTY* EMPLOYEE/OFFICIAL AND JOB TITLE	RELATIONSHIP TO COUNTY* EMPLOYEE/OFFICIAL	COUNTY* EMPLOYEE'S/OFFICIAL'S DEPARTMENT
N/A			

* County employee means Clark County, Department of Aviation, Clark County Detention Center or Clark County Water Reclamation District.

"Consanguinity" is a relationship by blood. "Affinity" is a relationship by marriage.

"To the second degree of consanguinity" applies to the candidate's first and second degree of blood relatives as follows:

- Spouse – Registered Domestic Partners – Children – Parents – In-laws (first degree)
- Brothers/Sisters – Half-Brothers/Half-Sisters – Grandchildren – Grandparents – In-laws (second degree)

For County Use Only:

If any Disclosure of Relationship is noted above, please complete the following:

- Yes No Is the County employee(s) noted above involved in the contracting/selection process for this particular agenda item?
- Yes No Is the County employee(s) noted above involved in any way with the business in performance of the contract?

Notes/Comments:

Jennifer Fox

Signature

Jennifer Fox

Print Name

Authorized Department Representative

Family to Family Connection, ISD 13
Board Members
Non-Profit Tax ID 88-0397827

Shannon Bilbray-Axelrod (President)
Nevada State Assemblywoman
7820 Silver Plateau Ave.
Las Vegas, NV 89128
Cell: 702-280-2060
sbilbray@gmail.com

Karen Wilkes (Vice-President)
Former Insurance Broker
Published Author
1302 Mountain View Pl
Boulder City, NV 89005
Cell: 702-277-1647
Karen@dmartnevada.com

Kammy Bridge
NORTHCAP
Tivoli Village
400 S. Rampart Blvd., Suite 220
Las Vegas, NV 89145
Cell: 702-525-1068
kammybridge@yahoo.com

Michaelene (Mikey) Bilbray
3128 Beach View Court
Las Vegas, NV 89117
Phone: 702-281-8295
mmbilbraylv@gmail.com

Lillie Englund, Ph.D. (Treasurer)
Former Kindergarten Teacher,
Pre-school Director, UNLV Instructor
4025 Montoya Avenue
Las Vegas, NV 89120
Phone: 702-278-6911
lillieenglund@cox.net

Jenny Gentleman
11717 La Mirago Place
Las Vegas, NV 89138
jennygentleman@gmail.com

Marsha Hayes (Secretary)
F2F Program Instructor
Proponent of Developmental Assets
109 S. Royal Ascot Drive
Las Vegas, NV 89144
Home: 702-256-1548
Cell: 702-469-4634
Sk8Hayes@aol.com

Karyna Armstrong, Esq.
McDonald Carano
2300 West Sahara Avenue, Suite 1200
Las Vegas, NV 89102
Office: 702-873-4100
Direct: 702-257-4532
karmstrong@mcdonaldcarano.com

Dawn L. Davis, Esq.
Snell & Wilmer L.L.P.
3883 Howard Hughes Parkway, Suite 1100
Las Vegas, NV 89169
Phone: 702-784-5275
ddavis@swlaw.com

Staff Contact:
Jennifer Fox, M.A. (Executive Director)
Family to Family Connection
3900 Cambridge Street, Suite 107
Las Vegas, NV 89119
Office: 702-870-9583
Cell: 702-285-5486
www.family2familylv.org
jenniferf2f@hotmail.com

Christen Leach OTD, MOT, OTR/L, BCP
AOTA Board Certification in Pediatrics
Assistant Professor, Touro University Nevada
School of Occupational Therapy
874 American Pacific Drive
Henderson, NV 89014
Office: 702-777-3134
cleach2@touro.edu

Advisory Board

Tina M. Walls, Esq.	Cheryl Smith
Lousie Helton	Sandy Miller
Candace Young-Richey	Carolyn Wheeler, ED
Nicole King, Esq.	Ulyanna Chung
Stacey Hatfield	Leah Cashman



E Katie Ave

FRENCH OAKS

PM 51-29

PM 61-82

S Maryland Pkwy

3900 Cambridge Street
Las Vegas, NV 89119
APN 162-15-702-011

75m

200ft

MARYLAND CROSSING AMD

GISMO

SUITE(S)	TENANT	
101-105	NEVADA HEALTH CENTER	5,745 SF
106	FAMILY TO FAMILY CONNECTION	548 SF
107	FAMILY TO FAMILY CONNECTION	1,471 SF
108	FAMILY TO FAMILY CONNECTION	766 SF

SUITE(S)	TENANT	
109	MULTI-PURPOSE ROOM	994 SF
110	VIETNAMESE-AMERICAN COMMUNITY	1,064 SF
111	NEIGHBORHOOD SERVICES	1,103 SF
	COMMON	3,162 SF

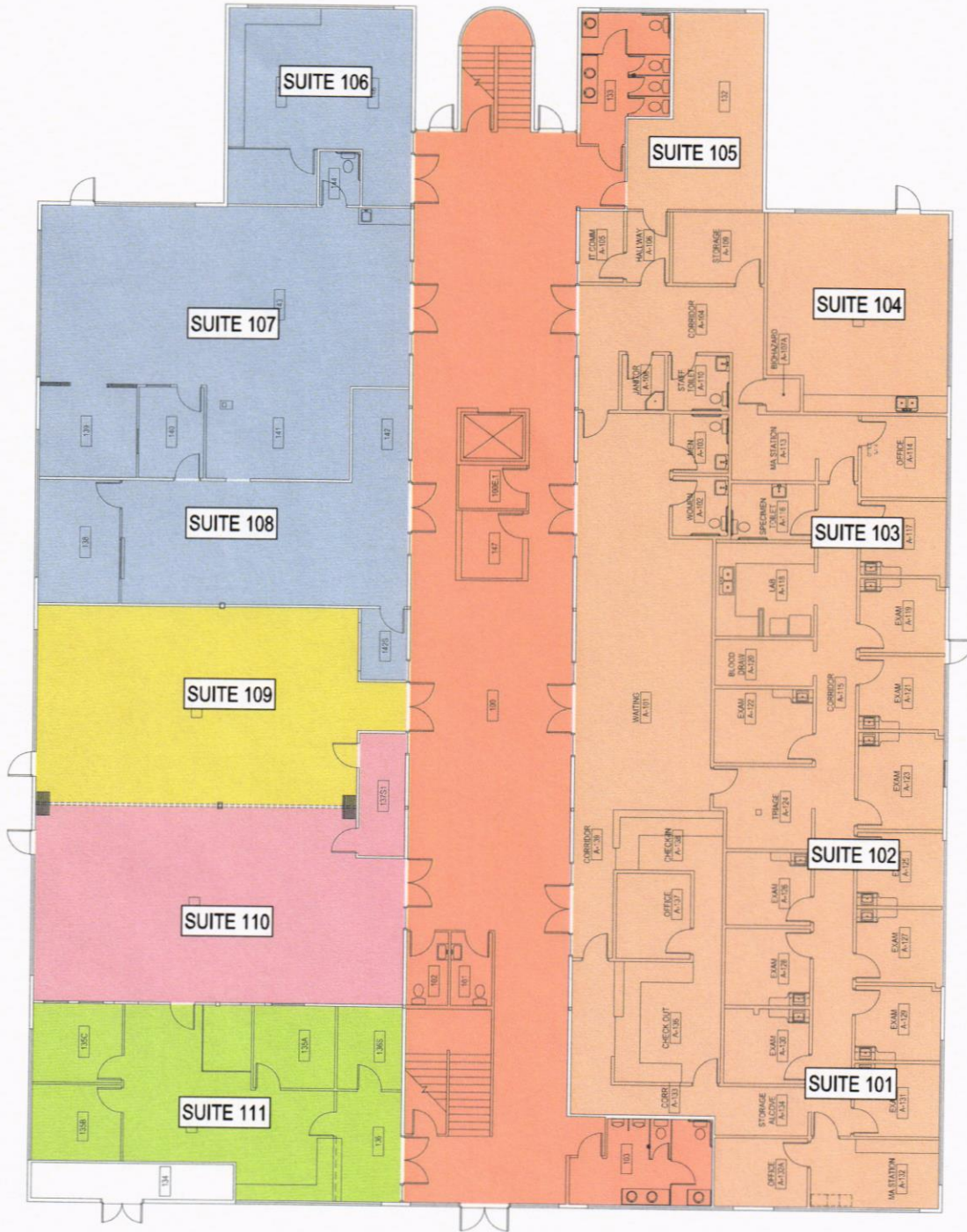

FIRST FLOOR PLAN

3900 CAMBRIDGE ST, LAS VEGAS 89119

NOT TO SCALE
8/28/2023

