

DISCLOSURE OF OWNERSHIP/PRINCIPALS

Business Entity Type (Please select one)						
<input type="checkbox"/> Sole Proprietorship	<input type="checkbox"/> Partnership	<input checked="" type="checkbox"/> Limited Liability Company	<input type="checkbox"/> Corporation	<input type="checkbox"/> Trust	<input type="checkbox"/> Non-Profit Organization	<input type="checkbox"/> Other
Business Designation Group (Please select all that apply)						
<input type="checkbox"/> MBE	<input type="checkbox"/> WBE	<input type="checkbox"/> SBE	<input type="checkbox"/> PBE	<input type="checkbox"/> VET	<input type="checkbox"/> DVET	<input type="checkbox"/> ESB
Minority Business Enterprise	Women-Owned Business Enterprise	Small Business Enterprise	Physically Challenged Business Enterprise	Veteran Owned Business	Disabled Veteran Owned Business	Emerging Small Business
Number of Clark County Nevada Residents Employed:				27		
Corporate/Business Entity Name:		StoryBook - Rosanna, LLC				
(Include d.b.a., if applicable)						
Street Address:		3625 S. Town Center Dr		Website: sbhlv.com		
City, State and Zip Code:		Las Vegas, Nevada 89135		POC Name: James Cooper		
				Email: jcooper@sbhlv.com		
Telephone No:		702 877-7040		Fax No: 702 877-7045		
Nevada Local Street Address:				Website:		
(If different from above)						
City, State and Zip Code:				Local Fax No:		
Local Telephone No:				Local POC Name:		
				Email:		

All entities, with the exception of publicly-traded and non-profit organizations, must list the names of individuals holding more than five percent (5%) ownership or financial interest in the business entity appearing before the Board.

Publicly-traded entities and non-profit organizations shall list all Corporate Officers and Directors in lieu of disclosing the names of individuals with ownership or financial interest. The disclosure requirement, as applied to land-use applications, extends to the applicant and the landowner(s).

Entities include all business associations organized under or governed by Title 7 of the Nevada Revised Statutes, including but not limited to private corporations, close corporations, foreign corporations, limited liability companies, partnerships, limited partnerships, and professional corporations.

Full Name	Title	% Owned (Not required for Publicly Traded Corporations/Non-profit organizations)
Wayne Laska	Manager	

This section is not required for publicly-traded corporations. Are you a publicly-traded corporation?

☐ Yes ☒ No

1. Are any individual members, partners, owners or principals, involved in the business entity, a Clark County, Department of Aviation, Clark County Detention Center or Clark County Water Reclamation District full-time employee(s), or appointed/elected official(s)?

☐ Yes ☒ No

(If yes, please note that County employee(s), or appointed/elected official(s) may not perform any work on professional service contracts, or other contracts, which are not subject to competitive bid.)

2. Do any individual members, partners, owners or principals have a spouse, registered domestic partner, child, parent, in-law or brother/sister, half-brother/half-sister, grandchild, grandparent, related to a Clark County, Department of Aviation, Clark County Detention Center or Clark County Water Reclamation District full-time employee(s), or appointed/elected official(s)?

☐ Yes ☐ No

(If yes, please complete the Disclosure of Relationship form on Page 2. If no, please print N/A on Page 2.)

I certify under penalty of perjury, that all of the information provided herein is current, complete, and accurate. I also understand that the Board will not take action on land-use approvals, contract approvals, land sales, leases or exchanges without the completed disclosure form.

<p></p> <p>Signature _____</p> <p></p> <p>Title _____</p>	<p></p> <p>Print Name _____</p> <p></p> <p>Date _____</p>
---	---

DISCLOSURE OF RELATIONSHIP

List any disclosures below:
(Mark N/A, if not applicable.)

NAME OF BUSINESS OWNER/PRINCIPAL	NAME OF COUNTY* EMPLOYEE/OFFICIAL AND JOB TITLE	RELATIONSHIP TO COUNTY* EMPLOYEE/OFFICIAL	COUNTY* EMPLOYEE'S/OFFICIAL'S DEPARTMENT
n/a			

* County employee means Clark County, Department of Aviation, Clark County Detention Center or Clark County Water Reclamation District.

"Consanguinity" is a relationship by blood. "Affinity" is a relationship by marriage.

"To the second degree of consanguinity" applies to the candidate's first and second degree of blood relatives as follows:

- Spouse – Registered Domestic Partners – Children – Parents – In-laws (first degree)
- Brothers/Sisters – Half-Brothers/Half-Sisters – Grandchildren – Grandparents – In-laws (second degree)

For County Use Only:

If any Disclosure of Relationship is noted above, please complete the following:

- ☐ Yes ☐ No Is the County employee(s) noted above involved in the contracting/selection process for this particular agenda item?
- ☐ Yes ☐ No Is the County employee(s) noted above involved in any way with the business in performance of the contract?

Notes/Comments:

Signature

Print Name
Authorized Department Representative

APN: A Portion of 163-34-501-016

DEDICATION

County of Clark, a political subdivision of the State of Nevada, "Dedicator", does hereby dedicate for public purposes, including but not limited to pedestrian access, utility, drainage or roadway purposes, that tract or parcel of land located in the County of Clark, State of Nevada, described as follows:

See Exhibits "A" and "B" attached hereto and by this reference made a part hereof,
a portion of Assessor's Parcel Number 163-34-501-016

In the event the land herein described, or any portion thereof, shall cease to be used for a public roadway, utility and/or drainage purposes and the land is to be vacated to a private entity, then the Clark County Board of County Commissioners (BCC) shall, as a condition of the vacation require the private entity receiving the vacated land to pay fair market value and such proceeds shall be distributed in accordance with Section 4(g)(4) of the Southern Nevada Public Land Management Act of 1998.

IN WITNESS WHEREOF, we have hereunto set our hands this _____ day of _____ 2021.

COUNTY OF CLARK, a political subdivision of the State of Nevada

Lisa Kremer, Director
Director of Real Property Management

STATE OF NEVADA)
COUNTY OF CLARK)

On the _____ day of _____ 2021, personally appeared before me, the undersigned, a Notary Public in and for the State of Nevada, _____ personally known (or proved) to me to be the person whose name is subscribed to the above instrument and who acknowledged to me that he executed the same voluntarily and for the uses and purposes therein mentioned.

IN WITNESS WHEREOF I have hereunto set my hand and affixed my official seal the day and year in this certificate first above written.

Notary Public in and for said County and State

My commission expires: _____

When recorded, return document to

County of Clark - RPM
500 S. Grand Central Pkwy., 4th Floor
Las Vegas, NV 89155-1825
Attention: Jaime McGinty

A.P.N. 163-34-501-016

OWNER: County of Clark, a Political Subdivision of the State of Nevada

EXHIBIT A

TRI-CORE SURVEYING, LLC
6753 WEST CHARLESTON BLVD.
LAS VEGAS, NV 89146

File: 04020.0001\Lgl_Rosanna_RW.doc

By: RF

Date: September 25, 2020

Page 1 of 2

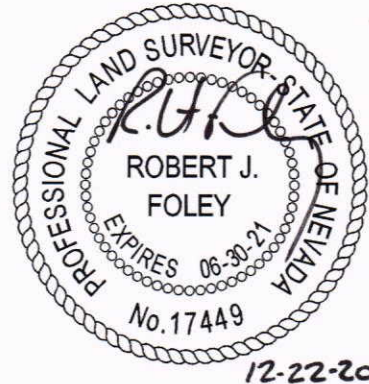

EXPLANATION

THIS LEGAL DESCRIPTION DESCRIBES A PARCEL OF LAND LOCATED AT THE SOUTHWEST CORNER OF ROSANNA STREET AND QUAIL AVENUE FOR PUBLIC RIGHT-OF-WAY DEDICATION PURPOSES.

LEGAL DESCRIPTION

THAT PORTION OF THE NORTHEAST QUARTER (NE 1/4) OF THE SOUTHWEST QUARTER (SW 1/4) OF THE NORTHEAST QUARTER (NE 1/4) OF SECTION 34, TOWNSHIP 21 SOUTH, RANGE 60 EAST, M.D.M., CLARK COUNTY, NEVADA, DESCRIBED AS FOLLOWS:

BEGINNING AT THE NORTHEAST CORNER OF SAID NORTHEAST QUARTER (NE 1/4) OF THE SOUTHWEST QUARTER (SW 1/4) OF THE NORTHEAST QUARTER (NE 1/4) OF SECTION 34, BEING THE CENTERLINE INTERSECTION OF ROSANNA STREET AND QUAIL AVENUE; THENCE SOUTH 00°56'07" EAST ALONG THE EAST LINE OF SAID NORTHEAST QUARTER (NE 1/4) A DISTANCE OF 24.45 FEET TO THE BEGINNING OF A NON-TANGENT CURVE CONCAVE NORTHEASTERLY HAVING A RADIUS OF 55.00 FEET, TO WHICH A RADIAL LINE BEARS SOUTH 26°06'02" WEST; THENCE DEPARTING SAID EAST LINE, NORTHWESTERLY 35.50 FEET ALONG THE ARC OF SAID CURVE THROUGH A CENTRAL ANGLE OF 36°59'03" TO THE NORTH LINE OF SAID NORTHEAST QUARTER (NE 1/4) OF THE SOUTHWEST QUARTER (SW 1/4) OF THE NORTHEAST QUARTER (NE 1/4) OF SECTION 34; THENCE SOUTH 89°52'47" EAST ALONG SAID NORTH LINE A DISTANCE OF 24.45 FEET TO THE **POINT OF BEGINNING**, AS SHOWN ON "**EXHIBIT B**" ATTACHED HERETO AND MADE A PART HEREOF.

BASIS OF BEARINGS

NORTH 00°56'45" WEST BEING THE BEARING OF THE EAST LINE OF THE NORTHEAST QUARTER (NE 1/4) OF THE NORTHEAST QUARTER (NE 1/4) OF SECTION 34, TOWNSHIP 21 SOUTH, RANGE 60 EAST, M.D.M., CLARK COUNTY, NEVADA AS SHOWN BY MAP THEREOF ON FILE IN THE CLARK COUNTY RECORDER'S OFFICE IN FILE 124, PAGE 41 OF PARCEL MAPS.

END OF DESCRIPTION

APN: 163-34-501-016

GRANTOR: County of Clark, a Political Subdivision
of the State of Nevada



RUSSELL ROAD

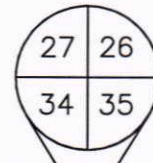

RUSSELL /
MONTESSOURI
BOOK 67, PAGE 82
OF PLATS

ROSANNA STREET
PUBLIC R/W PER
OR:19950405:01262

APN-163-34-501-011
SW 1/4, NE 1/4,
NE 1/4, NE 1/4
O.R.20201201:02249

QUAIL AVENUE

S89°52'47"E 670.42'

P.O.B.

S00°56'07"E
24.45'

661.19'
1322.39'

RAINBOW BOULEVARD

A PORTION OF
APN-163-34-501-016
NE 1/4, SW 1/4,
NE 1/4, NE 1/4
CLARK COUNTY
O.R.19990402:01640

APN-163-34-501-017
NW 1/4, SE 1/4,
NE 1/4, NE 1/4
O.R.20201201:02249

661.20'
N00°56'45"W

BASIS OF BEARINGS

S63°05'05"W
(R)
R=55.00'
Δ=36°59'03"
L=35.50'
S26°06'02"W
(R)

OQUENDO ROAD

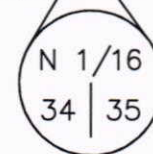

LINE TABLE		
LINE	BEARING	LENGTH
L1	S89°52'47"E	24.45'

EXHIBIT B
PAGE 2 OF 2

04020.0004
LGL_ROSANNA_RW



TRI-CORE
SURVEYING, LLC

6753 WEST CHARLESTON BLVD.
LAS VEGAS, NEVADA 89146
(702) 821-1554