

APN: A Portion of 162-20-212-003

DEDICATION

County of Clark, a political subdivision of the State of Nevada, "Dedicator", does hereby dedicate to County of Clark, by and through its Department of Public Works, a political subdivision of the State of Nevada, for public purposes, including but not limited to pedestrian access, utility, drainage or roadway purposes, that tract or parcel of land located in the County of Clark, State of Nevada, described as follows:

See Exhibits "A" and "B" attached hereto and by this reference made a part hereof,
a portion of Assessor's Parcel Number 162-20-212-003

IN WITNESS WHEREOF, we have hereunto set our hands this _____ day of _____ 2021.

COUNTY OF CLARK, a political subdivision of the State of Nevada

Lisa Kremer, Director
Director of Real Property Management

STATE OF NEVADA)
COUNTY OF CLARK)

On the _____ day of _____ 2021, personally appeared before me, the undersigned, a Notary Public in and for the State of Nevada, _____ personally known (or proved) to me to be the person whose name is subscribed to the above instrument and who acknowledged to me that he executed the same voluntarily and for the uses and purposes therein mentioned.

IN WITNESS WHEREOF I have hereunto set my hand and affixed my official seal the day and year in this certificate first above written.

Notary Public in and for said County and State

My commission expires: _____

When recorded, return document to

County of Clark - RPM
500 S. Grand Central Pkwy., 4th Floor
Las Vegas, NV 89155-1825
Attention: Jaime McGinty

**OWNER: COUNTY OF CLARK
APN 162-20-212-003**

**EXHIBIT "A"
DESCRIPTION**

A PORTION OF LOT 1 AS SHOWN IN BOOK 103, PAGE 94 OF PLATS, ON FILE IN THE CLARK COUNTY, NEVADA, RECORDER'S OFFICE, LYING WITHIN THE NORTHWEST QUARTER (NW 1/4) OF SECTION 20, TOWNSHIP 21 SOUTH, RANGE 61 EAST, M.D.M., CLARK COUNTY, NEVADA, DESCRIBED AS FOLLOWS:

COMMENCING AT THE SOUTHWEST CORNER OF SAID NORTHWEST QUARTER (NW 1/4); THENCE ALONG THE SOUTH LINE THEREOF, SOUTH 89°21'09" EAST, 903.47 FEET; THENCE DEPARTING SAID SOUTH LINE, NORTH 00°38'51" EAST, 40.00 FEET TO A POINT ON THE NORTHERLY RIGHT-OF-WAY OF HARMON AVENUE, DESCRIBED IN THAT GRANT, BARGAIN, SALE DEED RECORDED DECEMBER 24, 1996, IN BOOK 19961224 AS INSTRUMENT NUMBER 00895, ON FILE AT SAID RECORDER'S OFFICE, SAME POINT BEING THE SOUTHEAST CORNER OF SAID LOT 1 AS SHOWN IN FILE 121, PAGE 53 OF SURVEYS, ON FILE IN SAID RECORDER'S OFFICE, SAID POINT BEING THE **POINT OF BEGINNING**; THENCE ALONG THE SOUTH LINE OF SAID LOT 1 OF SAID PLAT AND NORTHERLY RIGHT-OF-WAY, NORTH 89°21'09" WEST, 38.53 FEET TO THE MOST SOUTHERLY SOUTHWEST CORNER OF SAID LOT 1 OF SAID PLAT; THENCE DEPARTING SAID NORTHERLY RIGHT-OF-WAY AND ALONG A WESTERLY LINE THEREOF, NORTH 00°00'21" WEST 341.28 FEET TO THE BEGINNING OF A CURVE, CONCAVE SOUTHWESTERLY, HAVING A RADIUS OF 35.00 FEET; THENCE NORTHWESTERLY ALONG SAID CURVE, THROUGH A CENTRAL ANGLE OF 89°59'59", AN ARC LENGTH OF 54.98 FEET TO A POINT ON A SOUTHERLY LINE OF SAID LOT 1; THENCE ALONG SAID SOUTHERLY LINE, SOUTH 89°59'39" WEST 293.76 FEET TO THE BEGINNING OF A NON-TANGENT CURVE, CONCAVE SOUTHEASTERLY, HAVING A RADIUS OF 475.50 FEET, TO WHICH A RADIAL LINE BEARS SOUTH 34°08'05" EAST; THENCE DEPARTING SAID SOUTHERLY LINE AND NORTHEASTERLY ALONG SAID CURVE THROUGH A CENTRAL ANGLE OF 16°45'08", AN ARC LENGTH OF 139.03 FEET, TO THE BEGINNING OF A COMPOUND CURVE, CONCAVE SOUTHERLY, HAVING A RADIUS OF 179.50 FEET, FROM WHICH BEGINNING THE RADIUS BEARS SOUTH 17°22'58" EAST; THENCE EASTERLY ALONG SAID CURVE, THROUGH A CENTRAL ANGLE OF 45°00'46", AN ARC LENGTH OF 141.02 FEET; THENCE SOUTH 76°39'39" EAST, 10.91 FEET TO THE BEGINNING OF A NON-TANGENT CURVE, CONCAVE SOUTHWESTERLY, HAVING A RADIUS OF 182.50 FEET, FROM WHICH BEGINNING THE RADIUS BEARS SOUTH 30°57'05" WEST; THENCE SOUTHEASTERLY ALONG SAID CURVE, THROUGH A CENTRAL ANGLE OF 41°06'57", AN ARC LENGTH OF 130.96 FEET; THENCE NORTH 89°51'26" EAST, 14.78 FEET TO A POINT ON THE EAST LINE OF SAID LOT 1 OF SAID SURVEY; THENCE ALONG THE EAST LINE THEREOF, SOUTH 00°05'31" EAST, 321.82 FEET TO THE **POINT OF BEGINNING**.

CONTAINS 27,852 SQUARE FEET, MORE OR LESS.

OWNER: COUNTY OF CLARK
APN 162-20-212-003

BASIS OF BEARINGS

SOUTH 89°21'09" EAST, BEING THE BEARING OF THE SOUTH LINE OF THE SOUTHWEST QUARTER (SW 1/4) OF THE NORTHWEST QUARTER (NW 1/4) OF SECTION 20, TOWNSHIP 21 SOUTH, RANGE 61 EAST, M.D.M., CLARK COUNTY, NEVADA, AS SHOWN IN FILE 219, PAGE 45 OF SURVEYS ON FILE AT THE CLARK COUNTY RECORDER'S OFFICE.

END OF DESCRIPTION

(SEE EXHIBIT "B" ATTACHED HERETO AND BY THIS REFERENCE MADE A PART HEREOF)

PAUL BURN, PLS
PROFESSIONAL LAND SURVEYOR
NEVADA LICENSE NO. 11174

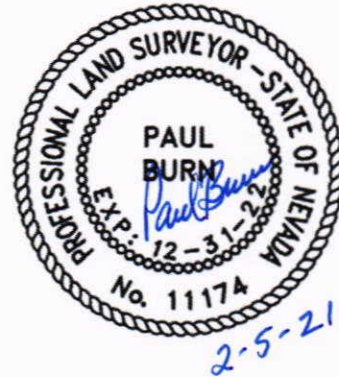

OWNER: COUNTY OF CLARK
APN: 162-20-212-003

EXHIBIT "B" TO ACCOMPANY DESCRIPTION

FOR LINE, RADIAL AND
CURVE TABLE SEE
PAGE 3 OF 3

MATCH LINE - SEE PAGE 2

S89°59'39"W 293.76'

OR: 20060926: 05946

PORTION OF LOT 1
BOOK 103, PAGE 94
OF PLATS
LOT 1, FILE 121,
PAGE 53 OF SURVEYS

AREA = 27,852 S.F.

OR: 19961224: 00895

903.47'

S89°21'09"E 1291.05'
BASIS OF BEARINGS

1/4 19 20
POINT OF
COMMENCEMENT

HARMON AVENUE
PUBLIC RIGHT-OF-WAY

PAGE 1 OF 3

GCV
ENGINEERS & SURVEYORS

1555 S. RAINBOW BLVD.
LAS VEGAS, NV 89146
T: 702.804.2000
F: 702.804.2299
gcvengineering.com

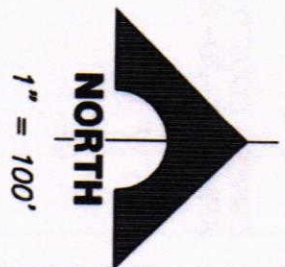

OR: 20020912: 00518

OR: 20100201: 01520

POINT OF
BEGINNING

N00°00'21"W 341.28'
S00°05'31"E 321.82'

L2

L1

387.58'

W1/16

EXHIBIT "B" TO ACCOMPANY DESCRIPTION

OWNER: COUNTY OF CLARK
APN: 162-20-212-003

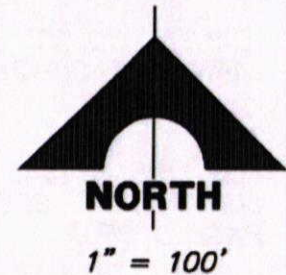

OR: 20060926: 05946

PORTION OF LOT 1
BOOK 103, PAGE 94
OF PLATS
LOT 1, FILE 121,
PAGE 53 OF SURVEYS

AREA = 27,851 S.F.

OR: 20020912: 00518

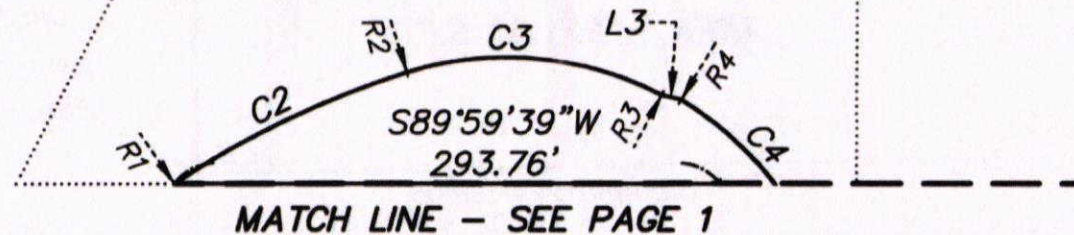

FOR LINE, RADIAL AND
CURVE TABLE SEE
PAGE 3 OF 3

PAGE 2 OF 3

GCV
ENGINEERS \ SURVEYORS

1555 S. RAINBOW BLVD.
LAS VEGAS, NV 89146
T: 702.804.2000
F: 702.804.2299
gcwengineering.com

F:\Projects\500-901A\Division\Survey\Exhibits\162-20-212-003 DED EX01.dwg

EXHIBIT "B" TO ACCOMPANY DESCRIPTION

OWNER: COUNTY OF CLARK
APN: 162-20-212-003

F:\Projects\500\500-901A\Division\Srvy\Exhibits\162-20-212-003 DED EX01.dwg

RADIAL TABLE	
LINE	BEARING
R1	S34°08'05"E
R2	N17°22'58"W
R3	N27°37'48"E
R4	S30°57'05"W
R5	N72°04'02"E

LINE TABLE		
LINE	BEARING	LENGTH
L1	N00°38'51"E	40.00'
L2	N89°21'09"W	38.53'
L3	S76°39'39"E	10.91'
L4	N89°51'26"E	14.78'

CURVE TABLE				
NO.	DELTA	RADIUS	LENGTH	TANGENT
C1	89°59'59"	35.00'	54.98'	35.00'
C2	16°45'08"	475.50'	139.03'	70.01'
C3	45°00'46"	179.50'	141.02'	74.37'
C4	41°06'57"	182.50'	130.96'	68.44'